

# FLAT WASHER FOR HEXAGON BOLTS AND NUTS

DIN 125 bare steel

<b>Norms</b>	DIN 125
<b>Material</b>	Steel
<b>Vickers hardness, HV</b>	140 HV
<b>Surface</b>	Bare
<b>RoHS-compliant</b>	Yes

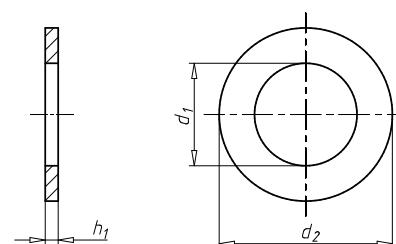

Suitable for screw thread	Internal diameter (d <sub>1</sub> )	Outer diameter (d <sub>2</sub> )	Thickness (h <sub>1</sub> )	Form	Art. No.	P. Qty.
M2	2.2 mm	5 mm	0.3 mm	A	<b>0405 2</b>	5000
M2.5	2.7 mm	6 mm	0.5 mm	A	<b>0405 25</b>	5000
M3	3.2 mm	7 mm	0.5 mm	A	<b>0405 3</b>	300/1000/10000
M3	3.2 mm	7 mm	0.5 mm	B	<b>0405 993</b>	10000
M4	4.3 mm	9 mm	0.8 mm	A	<b>0405 4</b>	100/1000/10000
M4	4.3 mm	9 mm	0.8 mm	B	<b>0405 994</b>	10000
M5	5.3 mm	10 mm	1 mm	A	<b>0405 5</b>	500/1000/5000
M5	5.3 mm	10 mm	1 mm	B	<b>0405 995</b>	5000
M6	6.4 mm	12 mm	1.6 mm	A	<b>0405 6</b>	500/1000
M6	6.4 mm	12 mm	1.6 mm	B	<b>0405 996</b>	2500
M7	7.4 mm	14 mm	1.6 mm	A	<b>0405 7</b>	100/2000
M8	8.4 mm	16 mm	1.6 mm	A	<b>0405 8</b>	100/1000/2000
M8	8.4 mm	16 mm	1.6 mm	B	<b>0405 998</b>	2000
M10	10.5 mm	20 mm	2 mm	A	<b>0405 10</b>	100/1000
M10	10.5 mm	21 mm	2 mm	B	<b>0405 991 0</b>	1000
M12	13 mm	24 mm	2.5 mm	A	<b>0405 12</b>	100/500/1000
M12	13 mm	24 mm	2.5 mm	B	<b>0405 991 2</b>	500
M14	15 mm	28 mm	2.5 mm	A	<b>0405 14</b>	100/500
M14	15 mm	28 mm	2.5 mm	B	<b>0405 991 4</b>	500
M16	17 mm	30 mm	3 mm	A	<b>0405 16</b>	100/500/600
M16	17 mm	30 mm	3 mm	B	<b>0405 991 6</b>	250
M18	19 mm	34 mm	3 mm	A	<b>0405 991 8</b>	200
M18	19 mm	34 mm	3 mm	B	<b>0405 18</b>	100/250
M20	21 mm	37 mm	3 mm	A	<b>0405 992 0</b>	200
M20	21 mm	37 mm	3 mm	B	<b>0405 20</b>	50/100/200
M22	23 mm	39 mm	3 mm	A	<b>0405 992 2</b>	200
M22	23 mm	39 mm	3 mm	B	<b>0405 22</b>	100/200
M24	25 mm	44 mm	4 mm	A	<b>0405 992 4</b>	100
M24	25 mm	44 mm	4 mm	B	<b>0405 24</b>	50/100
M26	27 mm	50 mm	4 mm	A	<b>0405 992 6</b>	50
M26	27 mm	50 mm	4 mm	B	<b>0405 26</b>	50
M27	28 mm	50 mm	4 mm	A	<b>0405 992 7</b>	100
M27	28 mm	50 mm	4 mm	B	<b>0405 27</b>	25/100
M28	29 mm	50 mm	4 mm	B	<b>0405 28</b>	25
M30	31 mm	56 mm	4 mm	A	<b>0405 993 0</b>	100
M30	31 mm	56 mm	4 mm	B	<b>0405 30</b>	5/50/100
M32	33 mm	60 mm	5 mm	A	<b>0405 993 2</b>	100
M32	33 mm	60 mm	5 mm	B	<b>0405 32</b>	5
M33	34 mm	60 mm	5 mm	A	<b>0405 993 3</b>	50
M33	34 mm	60 mm	5 mm	B	<b>0405 33</b>	50
M35	36 mm	66 mm	5 mm	A	<b>0405 993 5</b>	50