

Hexagonal bolt with shank

ISO 4014, steel 10.9, plain

Standards	ISO 4014
Material	Steel
Property class	10.9
Surface	Plain
RoHS-compliant	Yes

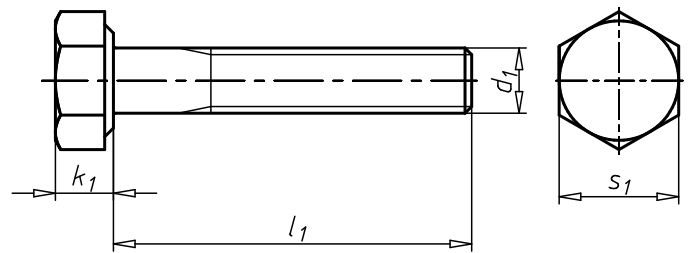

Thread type x nominal diameter (d ₁)	Length (l ₁)	Head height (k ₁)	Thread length (metric thread) (b)	External drive (s ₁)	Art. no.	P. Qty.
M6	30 mm	4 mm	18 mm	WS10	0052 6 30	500
M6	35 mm	4 mm	18 mm	WS10	0052 6 35	500
M6	40 mm	4 mm	18 mm	WS10	0052 6 40	200
M6	45 mm	4 mm	18 mm	WS10	0052 6 45	200
M6	50 mm	4 mm	18 mm	WS10	0052 6 50	200
M6	55 mm	4 mm	18 mm	WS10	0052 6 55	200
M6	60 mm	4 mm	18 mm	WS10	0052 6 60	200
M6	65 mm	4 mm	18 mm	WS10	0052 6 65	200
M6	70 mm	4 mm	18 mm	WS10	0052 6 70	200
M6	75 mm	4 mm	18 mm	WS10	0052 6 75	200
M6	80 mm	4 mm	18 mm	WS10	0052 6 80	200
M6	90 mm	4 mm	18 mm	WS10	0052 6 90	100
M6	100 mm	4 mm	18 mm	WS10	0052 6 100	100
M6	120 mm	4 mm	18 mm	WS10	0052 6 120	10
M6	130 mm	4 mm	24 mm	WS10	0052 6 130	10
M6	140 mm	4 mm	24 mm	WS10	0052 6 140	50
M6	240 mm	4 mm	37 mm	WS10	0052 6 240	50
M8	40 mm	5.3 mm	22 mm	WS13	0052 8 40	200
M8	45 mm	5.3 mm	22 mm	WS13	0052 8 45	200
M8	50 mm	5.3 mm	22 mm	WS13	0052 8 50	200
M8	55 mm	5.3 mm	22 mm	WS13	0052 8 55	200
M8	60 mm	5.3 mm	22 mm	WS13	0052 8 60	200
M8	65 mm	5.3 mm	22 mm	WS13	0052 8 65	200
M8	70 mm	5.3 mm	22 mm	WS13	0052 8 70	200
M8	75 mm	5.3 mm	22 mm	WS13	0052 8 75	200
M8	80 mm	5.3 mm	22 mm	WS13	0052 8 80	100
M8	85 mm	5.3 mm	22 mm	WS13	0052 8 85	100
M8	90 mm	5.3 mm	22 mm	WS13	0052 8 90	100
M8	95 mm	5.3 mm	22 mm	WS13	0052 8 95	25
M8	100 mm	5.3 mm	22 mm	WS13	0052 8 100	100
M8	110 mm	5.3 mm	22 mm	WS13	0052 8 110	100
M8	120 mm	5.3 mm	22 mm	WS13	0052 8 120	100

Thread type x nominal diameter (d ₁)	Length (l ₁)	Head height (k ₁)	Thread length (metric thread) (b)	External drive (s ₁)	Art. no.	P. Qty.
M8	130 mm	5.3 mm	28 mm	WS13	0052 8 130	100
M8	140 mm	5.3 mm	28 mm	WS13	0052 8 140	100
M8	150 mm	5.3 mm	28 mm	WS13	0052 8 150	50
M8	160 mm	5.3 mm	28 mm	WS13	0052 8 160	50
M8	180 mm	5.3 mm	28 mm	WS13	0052 8 180	50
M8	200 mm	5.3 mm	28 mm	WS13	0052 8 200	50
M10	45 mm	6.4 mm	26 mm	WS16	0052 910 45	100
M10	50 mm	6.4 mm	26 mm	WS16	0052 910 50	100
M10	55 mm	6.4 mm	26 mm	WS16	0052 910 55	100
M10	60 mm	6.4 mm	26 mm	WS16	0052 910 60	100
M10	70 mm	6.4 mm	26 mm	WS16	0052 910 70	100
M10	75 mm	6.4 mm	26 mm	WS16	0052 910 75	100
M10	80 mm	6.4 mm	26 mm	WS16	0052 910 80	50
M10	90 mm	6.4 mm	26 mm	WS16	0052 910 90	50
M10	95 mm	6.4 mm	26 mm	WS16	0052 910 95	100
M10	100 mm	6.4 mm	26 mm	WS16	0052 910 100	50
M10	120 mm	6.4 mm	26 mm	WS16	0052 910 120	100
M10	130 mm	6.4 mm	32 mm	WS16	0052 910 130	100
M10	140 mm	6.4 mm	32 mm	WS16	0052 910 140	50
M10	150 mm	6.4 mm	32 mm	WS16	0052 910 150	50
M10	190 mm	6.4 mm	32 mm	WS16	0052 910 190	50
M10	250 mm	6.4 mm	32 mm	WS16	0052 910 250	25
M12	50 mm	7.5 mm	30 mm	WS18	0052 912 50	100
M12	55 mm	7.5 mm	30 mm	WS18	0052 912 55	100
M12	60 mm	7.5 mm	30 mm	WS18	0052 912 60	100
M12	65 mm	7.5 mm	30 mm	WS18	0052 912 65	100
M12	70 mm	7.5 mm	30 mm	WS18	0052 912 70	50
M12	75 mm	7.5 mm	30 mm	WS18	0052 912 75	100
M12	80 mm	7.5 mm	30 mm	WS18	0052 912 80	50
M12	85 mm	7.5 mm	30 mm	WS18	0052 912 85	50
M12	90 mm	7.5 mm	30 mm	WS18	0052 912 90	50
M12	100 mm	7.5 mm	30 mm	WS18	0052 912 100	50
M12	110 mm	7.5 mm	30 mm	WS18	0052 912 110	50
M12	120 mm	7.5 mm	30 mm	WS18	0052 912 120	50
M12	130 mm	7.5 mm	36 mm	WS18	0052 912 130	50
M12	140 mm	7.5 mm	36 mm	WS18	0052 912 140	100
M12	150 mm	7.5 mm	36 mm	WS18	0052 912 150	25
M12	160 mm	7.5 mm	36 mm	WS18	0052 912 160	25
M12	170 mm	7.5 mm	36 mm	WS18	0052 912 170	25
M12	220 mm	7.5 mm	49 mm	WS18	0052 912 220	25
M14	55 mm	8.8 mm	34 mm	WS21	0052 914 55	50
M14	60 mm	8.8 mm	34 mm	WS21	0052 914 60	50
M14	65 mm	8.8 mm	34 mm	WS21	0052 914 65	50
M14	70 mm	8.8 mm	34 mm	WS21	0052 914 70	50
M14	75 mm	8.8 mm	34 mm	WS21	0052 914 75	50
M14	80 mm	8.8 mm	34 mm	WS21	0052 914 80	50
M14	90 mm	8.8 mm	34 mm	WS21	0052 914 90	50
M14	95 mm	8.8 mm	34 mm	WS21	0052 914 95	50
M14	100 mm	8.8 mm	34 mm	WS21	0052 914 100	50
M14	110 mm	8.8 mm	34 mm	WS21	0052 914 110	50
M14	120 mm	8.8 mm	34 mm	WS21	0052 914 120	25
M14	130 mm	8.8 mm	40 mm	WS21	0052 914 130	50
M14	150 mm	8.8 mm	40 mm	WS21	0052 914 150	25

Thread type x nominal diameter (d ₁)	Length (l ₁)	Head height (k ₁)	Thread length (metric thread) (b)	External drive (s ₁)	Art. no.	P. Qty.
M14	160 mm	8.8 mm	40 mm	WS21	0052 914 160	25
M14	200 mm	8.8 mm	40 mm	WS21	0052 914 200	1
M16	65 mm	10 mm	38 mm	WS24	0052 16 65	50
M16	70 mm	10 mm	38 mm	WS24	0052 16 70	25/50
M16	75 mm	10 mm	38 mm	WS24	0052 16 75	25
M16	80 mm	10 mm	38 mm	WS24	0052 16 80	25/50
M16	90 mm	10 mm	38 mm	WS24	0052 16 90	25/50
M16	95 mm	10 mm	38 mm	WS24	0052 16 95	25
M16	100 mm	10 mm	44 mm	WS24	0052 16 100	25
M16	105 mm	10 mm	38 mm	WS24	0052 16 105	25
M16	110 mm	10 mm	38 mm	WS24	0052 16 110	25
M16	115 mm	10 mm	38 mm	WS24	0052 16 115	25
M16	120 mm	10 mm	44 mm	WS24	0052 16 120	25
M16	125 mm	10 mm	44 mm	WS24	0052 16 125	25
M16	130 mm	10 mm	44 mm	WS24	0052 16 130	25
M16	135 mm	10 mm	44 mm	WS24	0052 16 135	25
M16	140 mm	10 mm	44 mm	WS24	0052 16 140	25
M16	145 mm	10 mm	44 mm	WS24	0052 16 145	1
M16	150 mm	10 mm	44 mm	WS24	0052 16 150	25
M16	155 mm	10 mm	44 mm	WS24	0052 16 155	25
M16	160 mm	10 mm	44 mm	WS24	0052 16 160	25
M16	170 mm	10 mm	44 mm	WS24	0052 16 170	25
M16	175 mm	10 mm	44 mm	WS24	0052 16 175	25
M16	180 mm	10 mm	44 mm	WS24	0052 16 180	25
M16	185 mm	10 mm	44 mm	WS24	0052 16 185	25
M16	190 mm	10 mm	57 mm	WS24	0052 16 190	25
M16	200 mm	10 mm	44 mm	WS24	0052 16 200	25
M16	210 mm	10 mm	57 mm	WS24	0052 16 210	25
M16	220 mm	10 mm	57 mm	WS24	0052 16 220	25
M16	230 mm	10 mm	57 mm	WS24	0052 16 230	25
M16	240 mm	10 mm	57 mm	WS24	0052 16 240	25
M16	250 mm	10 mm	57 mm	WS24	0052 16 250	25
M16	255 mm	10 mm	57 mm	WS24	0052 16 255	25
M16	260 mm	10 mm	57 mm	WS24	0052 16 260	25
M16	270 mm	10 mm	57 mm	WS24	0052 16 270	25
M16	280 mm	10 mm	57 mm	WS24	0052 16 280	25
M16	290 mm	10 mm	57 mm	WS24	0052 16 290	5
M16	300 mm	10 mm	57 mm	WS24	0052 16 300	25
M16	310 mm	10 mm	57 mm	WS24	0052 16 310	1
M16	320 mm	10 mm	57 mm	WS24	0052 16 320	10
M16	330 mm	10 mm	57 mm	WS24	0052 16 330	5
M16	340 mm	10 mm	57 mm	WS24	0052 16 340	10
M16	350 mm	10 mm	57 mm	WS24	0052 16 350	25
M16	360 mm	10 mm	57 mm	WS24	0052 16 360	25
M16	380 mm	10 mm	57 mm	WS24	0052 16 380	5
M16	400 mm	10 mm	57 mm	WS24	0052 16 400	10
M16	420 mm	10 mm	57 mm	WS24	0052 16 420	10
M16	520 mm	10 mm	57 mm	WS24	0052 16 520	5
M18	70 mm	11.5 mm	42 mm	WS27	0052 18 70	25
M18	75 mm	11.5 mm	42 mm	WS27	0052 18 75	25
M18	80 mm	11.5 mm	42 mm	WS27	0052 18 80	25
M18	85 mm	11.5 mm	42 mm	WS27	0052 18 85	1
M18	90 mm	11.5 mm	42 mm	WS27	0052 18 90	25

Thread type x nominal diameter (d ₁)	Length (l ₁)	Head height (k ₁)	Thread length (metric thread) (b)	External drive (s ₁)	Art. no.	P. Qty.
M18	100 mm	11.5 mm	42 mm	WS27	0052 18 100	25
M18	105 mm	11.5 mm	42 mm	WS27	0052 18 105	25
M18	110 mm	11.5 mm	42 mm	WS27	0052 18 110	25
M18	120 mm	11.5 mm	42 mm	WS27	0052 18 120	25
M18	130 mm	11.5 mm	48 mm	WS27	0052 18 130	25
M18	135 mm	11.5 mm	48 mm	WS27	0052 18 135	25
M18	140 mm	11.5 mm	48 mm	WS27	0052 18 140	25
M18	150 mm	11.5 mm	48 mm	WS27	0052 18 150	25
M18	160 mm	11.5 mm	48 mm	WS27	0052 18 160	25
M18	170 mm	11.5 mm	48 mm	WS27	0052 18 170	25
M18	180 mm	11.5 mm	48 mm	WS27	0052 18 180	25
M18	190 mm	11.5 mm	48 mm	WS27	0052 18 190	25
M18	220 mm	11.5 mm	61 mm	WS27	0052 18 220	25
M18	230 mm	11.5 mm	61 mm	WS27	0052 18 230	10
M18	240 mm	11.5 mm	61 mm	WS27	0052 18 240	25
M18	250 mm	11.5 mm	61 mm	WS27	0052 18 250	10
M18	260 mm	11.5 mm	61 mm	WS27	0052 18 260	25
M18	280 mm	11.5 mm	61 mm	WS27	0052 18 280	10
M20	75 mm	12.5 mm	46 mm	WS30	0052 20 75	25
M20	80 mm	12.5 mm	46 mm	WS30	0052 20 80	25
M20	85 mm	12.5 mm	46 mm	WS30	0052 20 85	25
M20	90 mm	12.5 mm	46 mm	WS30	0052 20 90	25
M20	95 mm	12.5 mm	46 mm	WS30	0052 20 95	25
M20	100 mm	12.5 mm	46 mm	WS30	0052 20 100	25
M20	110 mm	12.5 mm	46 mm	WS30	0052 20 110	25
M20	115 mm	12.5 mm	46 mm	WS30	0052 20 115	25
M20	120 mm	12.5 mm	46 mm	WS30	0052 20 120	25
M20	125 mm	12.5 mm	46 mm	WS30	0052 20 125	25
M20	130 mm	12.5 mm	52 mm	WS30	0052 20 130	25
M20	135 mm	12.5 mm	52 mm	WS30	0052 20 135	25
M20	140 mm	12.5 mm	52 mm	WS30	0052 20 140	25
M20	145 mm	12.5 mm	52 mm	WS30	0052 20 145	25
M20	150 mm	12.5 mm	52 mm	WS30	0052 20 150	25
M20	155 mm	12.5 mm	52 mm	WS30	0052 20 155	10
M20	160 mm	12.5 mm	52 mm	WS30	0052 20 160	25
M20	165 mm	12.5 mm	52 mm	WS30	0052 20 165	10
M20	170 mm	12.5 mm	52 mm	WS30	0052 20 170	10
M20	180 mm	12.5 mm	52 mm	WS30	0052 20 180	10
M20	190 mm	12.5 mm	52 mm	WS30	0052 20 190	10
M20	200 mm	12.5 mm	52 mm	WS30	0052 20 200	10
M20	210 mm	12.5 mm	65 mm	WS30	0052 20 210	10
M20	220 mm	12.5 mm	65 mm	WS30	0052 20 220	10
M20	230 mm	12.5 mm	65 mm	WS30	0052 20 230	10
M20	240 mm	12.5 mm	65 mm	WS30	0052 20 240	10
M20	250 mm	12.5 mm	65 mm	WS30	0052 20 250	10
M20	260 mm	12.5 mm	65 mm	WS30	0052 20 260	10
M20	270 mm	12.5 mm	65 mm	WS30	0052 20 270	10
M20	280 mm	12.5 mm	65 mm	WS30	0052 20 280	10
M20	290 mm	12.5 mm	65 mm	WS30	0052 20 290	10
M20	300 mm	12.5 mm	65 mm	WS30	0052 20 300	10
M20	310 mm	12.5 mm	65 mm	WS30	0052 20 310	10
M20	320 mm	12.5 mm	65 mm	WS30	0052 20 320	10
M20	340 mm	12.5 mm	65 mm	WS30	0052 20 340	10

Thread type x nominal diameter (d ₁)	Length (l ₁)	Head height (k ₁)	Thread length (metric thread) (b)	External drive (s ₁)	Art. no.	P. Qty.
M20	350 mm	12.5 mm	65 mm	WS30	0052 20 350	5
M20	360 mm	12.5 mm	65 mm	WS30	0052 20 360	10
M20	380 mm	12.5 mm	65 mm	WS30	0052 20 380	10
M20	400 mm	12.5 mm	65 mm	WS30	0052 20 400	10
M20	410 mm	12.5 mm	65 mm	WS30	0052 20 410	1
M20	420 mm	12.5 mm	65 mm	WS30	0052 20 420	15
M20	440 mm	12.5 mm	65 mm	WS30	0052 20 440	15
M22	90 mm	14 mm	50 mm	WS34	0052 922 90	25
M22	100 mm	14 mm	50 mm	WS34	0052 922 100	100
M22	150 mm	14 mm	56 mm	WS34	0052 922 150	25
M24	90 mm	15 mm	54 mm	WS36	0052 24 90	10
M24	95 mm	15 mm	54 mm	WS36	0052 24 95	10
M24	100 mm	15 mm	54 mm	WS36	0052 24 100	10
M24	105 mm	15 mm	54 mm	WS36	0052 24 105	10
M24	110 mm	15 mm	54 mm	WS36	0052 24 110	5/10
M24	115 mm	15 mm	54 mm	WS36	0052 24 115	5
M24	120 mm	15 mm	54 mm	WS36	0052 24 120	10
M24	130 mm	15 mm	60 mm	WS36	0052 24 130	10
M24	135 mm	15 mm	60 mm	WS36	0052 24 135	10
M24	140 mm	15 mm	60 mm	WS36	0052 24 140	10
M24	150 mm	15 mm	60 mm	WS36	0052 24 150	20
M24	155 mm	15 mm	60 mm	WS36	0052 24 155	1
M24	160 mm	15 mm	60 mm	WS36	0052 24 160	10
M24	165 mm	15 mm	60 mm	WS36	0052 24 165	10
M24	170 mm	15 mm	60 mm	WS36	0052 24 170	10
M24	180 mm	15 mm	60 mm	WS36	0052 24 180	10
M24	190 mm	15 mm	60 mm	WS36	0052 24 190	10
M24	200 mm	15 mm	60 mm	WS36	0052 24 200	10
M24	210 mm	15 mm	73 mm	WS36	0052 24 210	10
M24	220 mm	15 mm	73 mm	WS36	0052 24 220	10
M24	230 mm	15 mm	73 mm	WS36	0052 24 230	10
M24	240 mm	15 mm	73 mm	WS36	0052 24 240	10
M24	250 mm	15 mm	73 mm	WS36	0052 24 250	5
M24	260 mm	15 mm	73 mm	WS36	0052 24 260	5
M24	270 mm	15 mm	73 mm	WS36	0052 24 270	20
M24	280 mm	15 mm	73 mm	WS36	0052 24 280	10
M24	300 mm	15 mm	73 mm	WS36	0052 24 300	10
M24	310 mm	15 mm	73 mm	WS36	0052 24 310	10
M24	320 mm	15 mm	73 mm	WS36	0052 24 320	5
M24	340 mm	15 mm	73 mm	WS36	0052 24 340	5
M24	350 mm	15 mm	73 mm	WS36	0052 24 350	5
M24	360 mm	15 mm	73 mm	WS36	0052 24 360	10
M24	370 mm	15 mm	73 mm	WS36	0052 24 370	10
M24	380 mm	15 mm	73 mm	WS36	0052 24 380	10
M24	390 mm	15 mm	73 mm	WS36	0052 24 390	1
M24	400 mm	15 mm	73 mm	WS36	0052 24 400	1
M24	420 mm	15 mm	73 mm	WS36	0052 24 420	1
M24	440 mm	15 mm	73 mm	WS36	0052 24 440	5
M24	500 mm	15 mm	73 mm	WS36	0052 24 500	1
M24	540 mm	15 mm	73 mm	WS36	0052 24 540	10
M24	550 mm	15 mm	73 mm	WS36	0052 24 550	1
M24	560 mm	15 mm	73 mm	WS36	0052 24 560	1
M27	95 mm	17 mm	60 mm	WS41	0052 27 95	10

Thread type x nominal diameter (d ₁)	Length (l ₁)	Head height (k ₁)	Thread length (metric thread) (b)	External drive (s ₁)	Art. no.	P. Qty.
M27	100 mm	17 mm	60 mm	WS41	0052 27 100	10
M27	110 mm	17 mm	60 mm	WS41	0052 27 110	10
M27	120 mm	17 mm	60 mm	WS41	0052 27 120	5
M27	125 mm	17 mm	60 mm	WS41	0052 27 125	1
M27	130 mm	17 mm	66 mm	WS41	0052 27 130	10
M27	140 mm	17 mm	66 mm	WS41	0052 27 140	10
M27	145 mm	17 mm	66 mm	WS41	0052 27 145	10
M27	150 mm	17 mm	66 mm	WS41	0052 27 150	5
M27	160 mm	17 mm	66 mm	WS41	0052 27 160	10
M27	170 mm	17 mm	66 mm	WS41	0052 27 170	5
M27	185 mm	17 mm	66 mm	WS41	0052 27 185	5
M27	190 mm	17 mm	66 mm	WS41	0052 27 190	10
M27	200 mm	17 mm	66 mm	WS41	0052 27 200	10
M27	210 mm	17 mm	79 mm	WS41	0052 27 210	10
M27	220 mm	17 mm	79 mm	WS41	0052 27 220	10
M27	230 mm	17 mm	79 mm	WS41	0052 27 230	10
M27	240 mm	17 mm	79 mm	WS41	0052 27 240	10
M27	250 mm	17 mm	79 mm	WS41	0052 27 250	10
M27	260 mm	17 mm	79 mm	WS41	0052 27 260	10
M27	270 mm	17 mm	79 mm	WS41	0052 27 270	1
M27	280 mm	17 mm	79 mm	WS41	0052 27 280	10
M27	290 mm	17 mm	79 mm	WS41	0052 27 290	1
M27	300 mm	17 mm	79 mm	WS41	0052 27 300	5
M27	320 mm	17 mm	79 mm	WS41	0052 27 320	1
M30	110 mm	18.7 mm	66 mm	WS46	0052 30 110	10
M30	120 mm	18.7 mm	66 mm	WS46	0052 30 120	10
M30	125 mm	18.7 mm	66 mm	WS46	0052 30 125	10
M30	130 mm	18.7 mm	72 mm	WS46	0052 30 130	10
M30	160 mm	18.7 mm	72 mm	WS46	0052 30 160	10
M30	165 mm	18.7 mm	72 mm	WS46	0052 30 165	1
M30	170 mm	18.7 mm	72 mm	WS46	0052 30 170	10
M30	180 mm	18.7 mm	72 mm	WS46	0052 30 180	10
M30	190 mm	18.7 mm	72 mm	WS46	0052 30 190	5
M30	200 mm	18.7 mm	72 mm	WS46	0052 30 200	10
M30	210 mm	18.7 mm	85 mm	WS46	0052 30 210	10
M30	220 mm	18.7 mm	85 mm	WS46	0052 30 220	5
M30	230 mm	18.7 mm	85 mm	WS46	0052 30 230	10
M30	235 mm	18.7 mm	85 mm	WS46	0052 30 235	5
M30	240 mm	18.7 mm	85 mm	WS46	0052 30 240	10
M30	245 mm	18.7 mm	85 mm	WS46	0052 30 245	5
M30	260 mm	18.7 mm	85 mm	WS46	0052 30 260	10
M30	265 mm	18.7 mm	85 mm	WS46	0052 30 265	1
M30	270 mm	18.7 mm	85 mm	WS46	0052 30 270	10
M30	290 mm	18.7 mm	85 mm	WS46	0052 30 290	10
M30	320 mm	18.7 mm	85 mm	WS46	0052 30 320	10
M30	330 mm	18.7 mm	85 mm	WS46	0052 30 330	5
M30	340 mm	18.7 mm	85 mm	WS46	0052 30 340	5
M30	350 mm	18.7 mm	85 mm	WS46	0052 30 350	1
M30	360 mm	18.7 mm	85 mm	WS46	0052 30 360	10
M30	370 mm	18.7 mm	85 mm	WS46	0052 30 370	1
M30	380 mm	18.7 mm	85 mm	WS46	0052 30 380	10
M30	400 mm	18.7 mm	85 mm	WS46	0052 30 400	5
M30	420 mm	18.7 mm	85 mm	WS46	0052 30 420	8

Thread type x nominal diameter (d ₁)	Length (l ₁)	Head height (k ₁)	Thread length (metric thread) (b)	External drive (s ₁)	Art. no.	P. Qty.
M30	440 mm	18.7 mm	85 mm	WS46	0052 30 440	8
M30	460 mm	18.7 mm	85 mm	WS46	0052 30 460	1
M30	490 mm	18.7 mm	85 mm	WS46	0052 30 490	1
M30	500 mm	18.7 mm	85 mm	WS46	0052 30 500	1
M30	520 mm	18.7 mm	85 mm	WS46	0052 30 520	5
M30	540 mm	18.7 mm	85 mm	WS46	0052 30 540	1
M30	560 mm	18.7 mm	85 mm	WS46	0052 30 560	1
M30	600 mm	18.7 mm	85 mm	WS46	0052 30 600	1
M33	140 mm	21 mm	78 mm	WS50	0052 33 140	5
M33	160 mm	21 mm	78 mm	WS50	0052 33 160	1
M33	180 mm	21 mm	78 mm	WS50	0052 33 180	15
M33	190 mm	21 mm	78 mm	WS50	0052 33 190	10
M33	200 mm	21 mm	78 mm	WS50	0052 33 200	1
M33	260 mm	21 mm	91 mm	WS50	0052 33 260	1
M33	290 mm	21 mm	91 mm	WS50	0052 33 290	1
M33	320 mm	21 mm	91 mm	WS50	0052 33 320	1
M36	140 mm	22.5 mm	84 mm	WS55	0052 36 140	10
M36	150 mm	22.5 mm	84 mm	WS55	0052 36 150	10
M36	160 mm	22.5 mm	84 mm	WS55	0052 36 160	5
M36	170 mm	22.5 mm	84 mm	WS55	0052 36 170	10
M36	180 mm	22.5 mm	84 mm	WS55	0052 36 180	5
M36	190 mm	22.5 mm	84 mm	WS55	0052 36 190	10
M36	200 mm	22.5 mm	84 mm	WS55	0052 36 200	10
M36	210 mm	22.5 mm	97 mm	WS55	0052 36 210	1
M36	230 mm	22.5 mm	97 mm	WS55	0052 36 230	10
M36	240 mm	22.5 mm	97 mm	WS55	0052 36 240	5
M36	250 mm	22.5 mm	97 mm	WS55	0052 36 250	1
M36	265 mm	22.5 mm	97 mm	WS55	0052 36 265	5
M36	270 mm	22.5 mm	97 mm	WS55	0052 36 270	5
M36	280 mm	22.5 mm	97 mm	WS55	0052 36 280	10
M36	290 mm	22.5 mm	97 mm	WS55	0052 36 290	5
M36	300 mm	22.5 mm	97 mm	WS55	0052 36 300	1
M36	310 mm	22.5 mm	97 mm	WS55	0052 36 310	5
M36	330 mm	22.5 mm	97 mm	WS55	0052 36 330	1
M36	340 mm	22.5 mm	97 mm	WS55	0052 36 340	1
M36	360 mm	22.5 mm	97 mm	WS55	0052 36 360	10
M36	370 mm	22.5 mm	97 mm	WS55	0052 36 370	5
M36	375 mm	22.5 mm	97 mm	WS55	0052 36 375	1
M36	380 mm	22.5 mm	97 mm	WS55	0052 36 380	5/10
M36	420 mm	22.5 mm	97 mm	WS55	0052 36 420	5
M36	440 mm	22.5 mm	97 mm	WS55	0052 36 440	1
M36	490 mm	22.5 mm	97 mm	WS55	0052 36 490	1
M36	500 mm	22.5 mm	97 mm	WS55	0052 36 500	1
M36	700 mm	22.5 mm	97 mm	WS55	0052 36 700	1
M36	800 mm	22.5 mm	97 mm	WS55	0052 36 800	1
M39	150 mm	25 mm	90 mm	WS60	0052 39 150	10
M39	160 mm	25 mm	90 mm	WS60	0052 39 160	10
M39	170 mm	25 mm	90 mm	WS60	0052 39 170	1
M39	180 mm	25 mm	90 mm	WS60	0052 39 180	5
M39	220 mm	25 mm	103 mm	WS60	0052 39 220	1
M39	250 mm	25 mm	103 mm	WS60	0052 39 250	5
M39	400 mm	25 mm	103 mm	WS60	0052 39 400	1
M42	160 mm	26 mm	96 mm	WS65	0052 42 160	5

Thread type x nominal diameter (d ₁)	Length (l ₁)	Head height (k ₁)	Thread length (metric thread) (b)	External drive (s ₁)	Art. no.	P. Qty.
M42	170 mm	26 mm	96 mm	WS65	0052 42 170	5
M42	180 mm	26 mm	109 mm	WS65	0052 42 180	5
M42	200 mm	26 mm	109 mm	WS65	0052 42 200	5
M42	220 mm	26 mm	109 mm	WS65	0052 42 220	5
M42	240 mm	26 mm	109 mm	WS65	0052 42 240	5
M42	250 mm	26 mm	109 mm	WS65	0052 42 250	5
M42	280 mm	26 mm	109 mm	WS65	0052 42 280	5
M42	290 mm	26 mm	109 mm	WS65	0052 42 290	5
M42	300 mm	26 mm	109 mm	WS65	0052 42 300	1
M42	320 mm	26 mm	109 mm	WS65	0052 42 320	1
M42	340 mm	26 mm	109 mm	WS65	0052 42 340	5
M42	360 mm	26 mm	109 mm	WS65	0052 42 360	1
M42	370 mm	26 mm	109 mm	WS65	0052 42 370	1
M42	380 mm	26 mm	109 mm	WS65	0052 42 380	5
M42	400 mm	26 mm	109 mm	WS65	0052 42 400	1
M42	420 mm	26 mm	109 mm	WS65	0052 42 420	5
M42	430 mm	26 mm	109 mm	WS65	0052 42 430	1
M42	440 mm	26 mm	109 mm	WS65	0052 42 440	1
M42	450 mm	26 mm	109 mm	WS65	0052 42 450	1
M42	500 mm	26 mm	109 mm	WS65	0052 42 500	1
M42	520 mm	26 mm	109 mm	WS65	0052 42 520	1
M42	550 mm	26 mm	109 mm	WS65	0052 42 550	3
M45	180 mm	28 mm	102 mm	WS70	0052 45 180	5
M45	220 mm	28 mm	102 mm	WS70	0052 45 220	1
M48	170 mm	28 mm	108 mm	WS75	0052 48 170	1
M48	180 mm	28 mm	108 mm	WS75	0052 48 180	5
M48	200 mm	28 mm	121 mm	WS75	0052 48 200	5
M48	220 mm	28 mm	121 mm	WS75	0052 48 220	5
M48	230 mm	28 mm	121 mm	WS75	0052 48 230	1
M48	240 mm	28 mm	121 mm	WS75	0052 48 240	5
M48	260 mm	28 mm	121 mm	WS75	0052 48 260	5
M48	280 mm	30 mm	121 mm	WS75	0052 48 280	1
M48	300 mm	28 mm	121 mm	WS75	0052 48 300	2
M48	320 mm	28 mm	121 mm	WS75	0052 48 320	1
M48	340 mm	28 mm	121 mm	WS75	0052 48 340	5
M48	350 mm	28 mm	121 mm	WS75	0052 48 350	5
M48	360 mm	28 mm	121 mm	WS75	0052 48 360	1
M48	380 mm	28 mm	121 mm	WS75	0052 48 380	3
M48	400 mm	28 mm	121 mm	WS75	0052 48 400	5
M48	420 mm	28 mm	121 mm	WS75	0052 48 420	5
M48	500 mm	28 mm	121 mm	WS75	0052 48 500	1
M48	700 mm	28 mm	121 mm	WS75	0052 48 700	1
M48	760 mm	28 mm	121 mm	WS75	0052 48 760	1
M52	220 mm	33 mm	129 mm	WS80	0052 52 220	1
M56	250 mm	35 mm	137 mm	WS85	0052 56 250	1
M56	260 mm	35 mm	137 mm	WS85	0052 56 260	25
M56	280 mm	35 mm	137 mm	WS85	0052 56 280	25
M56	360 mm	35 mm	137 mm	WS85	0052 56 360	1
M64	500 mm	40 mm	153 mm	WS95	0052 64 500	1
M64	640 mm	40 mm	153 mm	WS95	0052 64 640	1

Notice

ISO 4014 replaces DIN 931 | There is some similarity | Nominal dimensions extended | Width across flats changed for M10, M12, M14 and M22.