

HEXAGONAL BOLT WITH SHANK

ISO 4014 stainless steel A4-50
and A4-70, plain

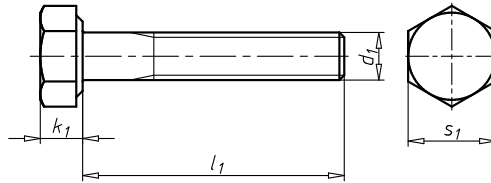

Thread type x nominal diameter (d ₁)	Length (l ₁)	Head height (k ₁)	External drive (s ₁)	Property class	Product class	Art. No.	P. Qty.
M30	90 mm	18.7 mm	WS46	50	B	0090 30 90	1
M30	100 mm	18.7 mm	WS46	50	B	0090 30 100	1
M30	110 mm	18.7 mm	WS46	50	B	0090 30 110	1
M30	120 mm	18.7 mm	WS46	50	B	0090 30 120	10
M30	130 mm	18.7 mm	WS46	50	B	0090 30 130	1
M30	140 mm	18.7 mm	WS46	50	B	0090 30 140	1
M30	150 mm	18.7 mm	WS46	50	B	0090 30 150	1
M30	160 mm	18.7 mm	WS46	50	B	0090 30 160	1
M30	180 mm	18.7 mm	WS46	50	B	0090 30 180	1
M30	190 mm	18.7 mm	WS46	50	B	0090 30 190	5
M30	200 mm	18.7 mm	WS46	50	B	0090 30 200	1
M30	210 mm	18.7 mm	WS46	50	B	0090 30 210	1
M30	220 mm	18.7 mm	WS46	50	B	0090 30 220	1
M30	240 mm	18.7 mm	WS46	50	B	0090 30 240	5
M30	260 mm	18.7 mm	WS46	50	B	0090 30 260	1
M36	110 mm	22.5 mm	WS55	50	B	0090 36 110	1
M36	120 mm	22.5 mm	WS55	50	B	0090 36 120	1
M36	130 mm	22.5 mm	WS55	50	B	0090 36 130	1
M36	140 mm	22.5 mm	WS55	50	B	0090 36 140	1
M36	150 mm	22.5 mm	WS55	50	B	0090 36 150	1
M36	160 mm	22.5 mm	WS55	50	B	0090 36 160	1
M36	170 mm	22.5 mm	WS55	50	B	0090 36 170	1
M36	180 mm	22.5 mm	WS55	50	B	0090 36 180	1
M36	200 mm	22.5 mm	WS55	50	B	0090 36 200	1
M36	210 mm	22.5 mm	WS55	50	B	0090 36 210	5
M36	230 mm	22.5 mm	WS55	50	B	0090 36 230	5
M36	240 mm	22.5 mm	WS55	50	B	0090 36 240	5
M36	250 mm	22.5 mm	WS55	50	B	0090 36 250	5