

COMPRESSION CABLE LUG

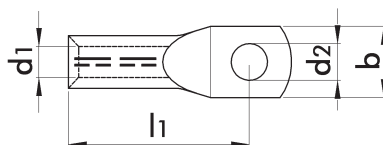

Illustration only



DIN 46235

- With markings for correct compression

Application area

For multi-wire, fine-wire and very fine wire copper conductors, such as compliant with DIN EN 60228 Class 2, 5 and 6

Notice

The user must check the inserted cable (using a pull-out test, if required).

Max. temperature resistance	125 °C
Material	Electrolytic copper
Surface	Tin-plated

Wire cross section	Flange hole	Code number according to standard	Wire diameter (d ₁)	Diameter of hole (d ₂)	Distance between sleeve end and centre of hole (l ₁)	Sleeve length	Width (b)	Art. No.	P. Qty.
6 mm ²	M5	5	3.8 mm	5.3 mm	24 mm	10 mm	8.5 mm	0967 506 5	100
6 mm ²	M6	5	3.8 mm	6.4 mm	24 mm	10 mm	8.5 mm	0967 506 6	100
6 mm ²	M8	5	3.8 mm	8.4 mm	27.5 mm	10 mm	13.5 mm	0967 506 8	100
10 mm ²	M5	6	4.5 mm	5.3 mm	27 mm	10 mm	9 mm	0967 510 5	100
10 mm ²	M6	6	4.5 mm	6.4 mm	27 mm	10 mm	9 mm	0967 510 6	100
10 mm ²	M8	6	4.5 mm	8.4 mm	27 mm	10.0 mm	13 mm	0967 510 8	100
16 mm ²	M6	8	5.5 mm	6.4 mm	36 mm	20.0 mm	13 mm	0967 516 6	100
16 mm ²	M8	8	5.5 mm	8.4 mm	36 mm	20 mm	13 mm	0967 516 8	100
16 mm ²	M10	8	5.5 mm	10.5 mm	36 mm	20 mm	17 mm	0967 516 10	100
16 mm ²	M12	8	5.5 mm	13 mm	36 mm	20 mm	18 mm	0967 516 12	100
25 mm ²	M6	10	7 mm	6.4 mm	38 mm	20 mm	14 mm	0967 525 6	100
25 mm ²	M8	10	7 mm	8.4 mm	38 mm	20 mm	16 mm	0967 525 8	100
25 mm ²	M10	10	7 mm	10.5 mm	38 mm	20 mm	17 mm	0967 525 10	100
25 mm ²	M12	10	7 mm	13 mm	38 mm	20 mm	19 mm	0967 525 12	100
35 mm ²	M6	12	8.2 mm	6.4 mm	42 mm	20 mm	17.2 mm	0967 535 6	50
35 mm ²	M8	12	8.2 mm	8.4 mm	42 mm	20 mm	17 mm	0967 535 8	50
35 mm ²	M10	12	8.2 mm	10.5 mm	42 mm	20 mm	19 mm	0967 535 10	50
35 mm ²	M12	12	8.2 mm	13 mm	42 mm	20 mm	21 mm	0967 535 12	50
50 mm ²	M8	14	10 mm	8.4 mm	52 mm	28 mm	20 mm	0967 550 8	25
50 mm ²	M10	14	10 mm	10.5 mm	52 mm	28 mm	22 mm	0967 550 10	25
50 mm ²	M12	14	10 mm	13 mm	52 mm	28 mm	24 mm	0967 550 12	25
50 mm ²	M16	14	10 mm	17 mm	55 mm	28 mm	28 mm	0967 550 16	25
70 mm ²	M8	16	11.5 mm	8.4 mm	55 mm	28 mm	24 mm	0967 570 8	25
70 mm ²	M10	16	11.5 mm	10.5 mm	55 mm	28 mm	24 mm	0967 570 10	25
70 mm ²	M12	16	11.5 mm	13 mm	55 mm	28 mm	24 mm	0967 570 12	25
70 mm ²	M16	16	11.5 mm	17 mm	55 mm	28 mm	30 mm	0967 570 16	25
95 mm ²	M8	18	13.5 mm	8.4 mm	65 mm	35 mm	28 mm	0967 595 8	25
95 mm ²	M10	18	13.5 mm	10.5 mm	65 mm	35 mm	28 mm	0967 595 10	25
95 mm ²	M12	18	13.5 mm	13 mm	65 mm	35 mm	28 mm	0967 595 12	25
95 mm ²	M16	18	13.5 mm	17 mm	65 mm	35 mm	32 mm	0967 595 16	25
120 mm ²	M10	20	15.5 mm	10.5 mm	70 mm	35 mm	32 mm	0967 512 010	25
120 mm ²	M12	20	15.5 mm	13 mm	70 mm	35 mm	32 mm	0967 512 012	25
120 mm ²	M16	20	15.5 mm	17 mm	70 mm	35 mm	32 mm	0967 512 016	25
120 mm ²	M20	20	15.5 mm	21 mm	70 mm	35 mm	38 mm	0967 512 020	25
150 mm ²	M10	22	17 mm	10.5 mm	78 mm	35 mm	34 mm	0967 515 010	10
150 mm ²	M12	22	17 mm	13 mm	78 mm	35 mm	34 mm	0967 515 012	10
150 mm ²	M16	22	17 mm	17 mm	78 mm	35 mm	34 mm	0967 515 016	10
150 mm ²	M20	22	17 mm	21 mm	78 mm	35 mm	40 mm	0967 515 020	10