

HEXAGONAL BOLT WITH SHANK

ISO 4014 stainless steel A4-50
and A4-70, plain

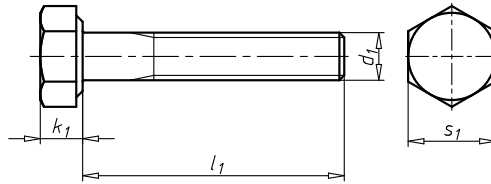

Thread type x nominal diameter (d ₁)	Length (l ₁)	Head height (k ₁)	External drive (s ₁)	Property class	Product class	Art. No.	P. Qty.
M8	35 mm	5.3 mm	WS13	70	A	0090 8 35	100
M8	40 mm	5.3 mm	WS13	70	A	0090 8 40	100
M8	45 mm	5.3 mm	WS13	70	A	0090 8 45	100
M8	50 mm	5.3 mm	WS13	70	A	0090 8 50	100
M8	55 mm	5.3 mm	WS13	70	A	0090 8 55	100
M8	60 mm	5.3 mm	WS13	70	A	0090 8 60	100
M8	65 mm	5.3 mm	WS13	70	A	0090 8 65	100
M8	70 mm	5.3 mm	WS13	70	A	0090 8 70	50
M8	75 mm	5.3 mm	WS13	70	A	0090 8 75	50
M8	80 mm	5.3 mm	WS13	70	A	0090 8 80	50
M8	85 mm	5.3 mm	WS13	70	B	0090 8 85	50
M8	90 mm	5.3 mm	WS13	70	B	0090 8 90	100
M8	100 mm	5.3 mm	WS13	70	B	0090 8 100	50
M8	110 mm	5.3 mm	WS13	70	B	0090 8 110	50
M8	120 mm	5.3 mm	WS13	70	B	0090 8 120	50
M8	130 mm	5.3 mm	WS13	70	B	0090 8 130	50
M8	140 mm	5.3 mm	WS13	70	B	0090 8 140	50
M8	150 mm	5.3 mm	WS13	70	B	0090 8 150	50
M8	160 mm	5.3 mm	WS13	70	B	0090 8 160	50
M8	170 mm	5.3 mm	WS13	70	B	0090 8 170	50
M8	180 mm	5.3 mm	WS13	70	B	0090 8 180	50
M8	190 mm	5.3 mm	WS13	70	B	0090 8 190	50
M10	45 mm	6.4 mm	WS16	70	A	0090 910 45	100
M10	50 mm	6.4 mm	WS16	70	A	0090 910 50	100
M10	55 mm	6.4 mm	WS16	70	A	0090 910 55	100
M10	60 mm	6.4 mm	WS16	70	A	0090 910 60	50
M10	65 mm	6.4 mm	WS16	70	A	0090 910 65	50
M10	70 mm	6.4 mm	WS16	70	A	0090 910 70	50
M10	75 mm	6.4 mm	WS16	70	A	0090 910 75	50
M10	80 mm	6.4 mm	WS16	70	A	0090 910 80	50
M10	90 mm	6.4 mm	WS16	70	A	0090 910 90	50
M10	95 mm	6.4 mm	WS16	70	A	0090 910 95	50
M10	100 mm	6.4 mm	WS16	70	A	0090 910 100	50
M10	110 mm	6.4 mm	WS16	70	B	0090 910 110	25
M10	115 mm	6.4 mm	WS16	70	B	0090 910 115	10
M10	120 mm	6.4 mm	WS16	70	B	0090 910 120	25
M10	130 mm	6.4 mm	WS16	70	B	0090 910 130	25
M10	160 mm	6.4 mm	WS16	70	B	0090 910 160	50