

Hexagonal bolt with shank

ISO 4014, steel 12.9, plain

Standards	ISO 4014
Material	Steel
Property class	12.9
Surface	Plain
RoHS-compliant	Yes

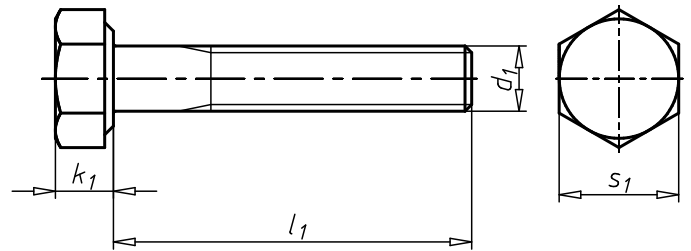

Thread type x nominal diameter (d ₁)	Length (l ₁)	Head height (k ₁)	Thread length (metric thread) (b)	External drive (s ₁)	Art. no.	P. Qty.
M8	45 mm	5.3 mm	22 mm	WS13	0054 8 45	200
M8	50 mm	5.3 mm	22 mm	WS13	0054 8 50	100
M8	60 mm	5.3 mm	22 mm	WS13	0054 8 60	100
M8	65 mm	5.3 mm	22 mm	WS13	0054 8 65	100
M8	70 mm	5.3 mm	22 mm	WS13	0054 8 70	100
M8	75 mm	5.3 mm	22 mm	WS13	0054 8 75	200
M8	80 mm	5.3 mm	22 mm	WS13	0054 8 80	200
M8	110 mm	5.3 mm	22 mm	WS13	0054 8 110	100
M10	45 mm	6.4 mm	26 mm	WS16	0054 910 45	100
M10	50 mm	6.4 mm	26 mm	WS16	0054 910 50	100
M10	65 mm	6.4 mm	26 mm	WS16	0054 910 65	50
M10	80 mm	6.4 mm	26 mm	WS16	0054 910 80	100
M12	60 mm	7.5 mm	30 mm	WS18	0054 912 60	50
M12	70 mm	7.5 mm	30 mm	WS18	0054 912 70	50
M12	90 mm	7.5 mm	30 mm	WS18	0054 912 90	50
M12	100 mm	7.5 mm	30 mm	WS18	0054 912 100	50
M12	110 mm	7.5 mm	30 mm	WS18	0054 912 110	50
M12	120 mm	7.5 mm	30 mm	WS18	0054 912 120	50
M12	150 mm	7.5 mm	36 mm	WS18	0054 912 150	50
M12	230 mm	7.5 mm	49 mm	WS18	0054 912 230	50
M14	120 mm	8.8 mm	34 mm	WS21	0054 914 120	50
M16	65 mm	10 mm	38 mm	WS24	0054 16 65	25
M16	70 mm	10 mm	38 mm	WS24	0054 16 70	25
M16	75 mm	10 mm	38 mm	WS24	0054 16 75	50
M16	80 mm	10 mm	38 mm	WS24	0054 16 80	25
M16	85 mm	10 mm	38 mm	WS24	0054 16 85	25
M16	90 mm	10 mm	38 mm	WS24	0054 16 90	25
M16	100 mm	10 mm	38 mm	WS24	0054 16 100	25
M16	110 mm	10 mm	38 mm	WS24	0054 16 110	30
M16	120 mm	10 mm	38 mm	WS24	0054 16 120	25
M16	130 mm	10 mm	44 mm	WS24	0054 16 130	25
M16	140 mm	10 mm	44 mm	WS24	0054 16 140	25

Thread type x nominal diameter (d ₁)	Length (l ₁)	Head height (k ₁)	Thread length (metric thread) (b)	External drive (s ₁)	Art. no.	P. Qty.
M16	150 mm	10 mm	44 mm	WS24	0054 16 150	25
M16	155 mm	10 mm	44 mm	WS24	0054 16 155	25
M16	160 mm	10 mm	44 mm	WS24	0054 16 160	25
M16	170 mm	10 mm	44 mm	WS24	0054 16 170	25
M16	180 mm	10 mm	44 mm	WS24	0054 16 180	25
M16	300 mm	10 mm	57 mm	WS24	0054 16 300	1
M16	310 mm	10 mm	57 mm	WS24	0054 16 310	30
M18	70 mm	11.5 mm	42 mm	WS27	0054 18 70	25
M18	80 mm	11.5 mm	42 mm	WS27	0054 18 80	10
M18	90 mm	11.5 mm	42 mm	WS27	0054 18 90	25
M18	110 mm	11.5 mm	42 mm	WS27	0054 18 110	25
M18	120 mm	11.5 mm	42 mm	WS27	0054 18 120	25
M18	160 mm	11.5 mm	48 mm	WS27	0054 18 160	25
M18	185 mm	11.5 mm	48 mm	WS27	0054 18 185	25
M18	210 mm	11.5 mm	61 mm	WS27	0054 18 210	15
M18	220 mm	11.5 mm	61 mm	WS27	0054 18 220	25
M20	80 mm	12.5 mm	46 mm	WS30	0054 20 80	25
M20	90 mm	12.5 mm	46 mm	WS30	0054 20 90	25
M20	95 mm	12.5 mm	46 mm	WS30	0054 20 95	25
M20	100 mm	12.5 mm	46 mm	WS30	0054 20 100	25
M20	110 mm	12.5 mm	46 mm	WS30	0054 20 110	25
M20	120 mm	12.5 mm	46 mm	WS30	0054 20 120	25
M20	130 mm	12.5 mm	52 mm	WS30	0054 20 130	25
M20	140 mm	12.5 mm	52 mm	WS30	0054 20 140	25
M20	150 mm	12.5 mm	52 mm	WS30	0054 20 150	25
M20	190 mm	12.5 mm	52 mm	WS30	0054 20 190	25
M20	200 mm	12.5 mm	52 mm	WS30	0054 20 200	10
M20	220 mm	12.5 mm	65 mm	WS30	0054 20 220	10
M20	240 mm	12.5 mm	65 mm	WS30	0054 20 240	10
M20	250 mm	12.5 mm	65 mm	WS30	0054 20 250	10
M20	260 mm	12.5 mm	65 mm	WS30	0054 20 260	10
M20	280 mm	12.5 mm	65 mm	WS30	0054 20 280	10
M20	300 mm	12.5 mm	65 mm	WS30	0054 20 300	14
M24	90 mm	15 mm	54 mm	WS36	0054 24 90	25
M24	100 mm	15 mm	54 mm	WS36	0054 24 100	10
M24	110 mm	15 mm	54 mm	WS36	0054 24 110	10
M24	120 mm	15 mm	54 mm	WS36	0054 24 120	10
M24	130 mm	15 mm	60 mm	WS36	0054 24 130	10
M24	140 mm	15 mm	60 mm	WS36	0054 24 140	10
M24	160 mm	15 mm	60 mm	WS36	0054 24 160	10
M24	170 mm	15 mm	60 mm	WS36	0054 24 170	10
M24	180 mm	15 mm	60 mm	WS36	0054 24 180	10
M24	220 mm	15 mm	73 mm	WS36	0054 24 220	1
M24	240 mm	15 mm	73 mm	WS36	0054 24 240	1
M24	250 mm	15 mm	73 mm	WS36	0054 24 250	10
M24	260 mm	15 mm	73 mm	WS36	0054 24 260	10
M24	270 mm	15 mm	73 mm	WS36	0054 24 270	10
M24	290 mm	15 mm	73 mm	WS36	0054 24 290	1
M24	320 mm	15 mm	73 mm	WS36	0054 24 320	10
M24	340 mm	15 mm	73 mm	WS36	0054 24 340	10
M24	350 mm	15 mm	73 mm	WS36	0054 24 350	10
M27	120 mm	17 mm	60 mm	WS41	0054 27 120	10
M27	180 mm	17 mm	66 mm	WS41	0054 27 180	10

Thread type x nominal diameter (d ₁)	Length (l ₁)	Head height (k ₁)	Thread length (metric thread) (b)	External drive (s ₁)	Art. no.	P. Qty.
M27	220 mm	17 mm	79 mm	WS41	0054 27 220	10
M27	350 mm	17 mm	79 mm	WS41	0054 27 350	1
M30	110 mm	18.7 mm	66 mm	WS46	0054 30 110	10
M30	120 mm	18.7 mm	66 mm	WS46	0054 30 120	10
M30	130 mm	18.7 mm	72 mm	WS46	0054 30 130	10
M30	140 mm	18.7 mm	72 mm	WS46	0054 30 140	5
M30	150 mm	18.7 mm	72 mm	WS46	0054 30 150	10
M30	160 mm	18.7 mm	72 mm	WS46	0054 30 160	5
M30	180 mm	18.7 mm	72 mm	WS46	0054 30 180	10
M30	200 mm	18.7 mm	72 mm	WS46	0054 30 200	5
M30	220 mm	18.7 mm	85 mm	WS46	0054 30 220	5
M30	240 mm	18.7 mm	85 mm	WS46	0054 30 240	5
M30	250 mm	18.7 mm	85 mm	WS46	0054 30 250	5
M30	260 mm	18.7 mm	85 mm	WS46	0054 30 260	1
M30	300 mm	18.7 mm	85 mm	WS46	0054 30 300	10
M33	130 mm	21 mm	78 mm	WS50	0054 33 130	5
M33	140 mm	21 mm	78 mm	WS50	0054 33 140	10
M33	300 mm	21 mm	91 mm	WS50	0054 33 300	5
M36	150 mm	22.5 mm	84 mm	WS55	0054 36 150	5
M36	180 mm	22.5 mm	84 mm	WS55	0054 36 180	10
M36	200 mm	22.5 mm	84 mm	WS55	0054 36 200	1
M36	240 mm	22.5 mm	97 mm	WS55	0054 36 240	1
M36	280 mm	22.5 mm	97 mm	WS55	0054 36 280	8
M36	300 mm	22.5 mm	97 mm	WS55	0054 36 300	1
M36	640 mm	22.5 mm	97 mm	WS55	0054 36 640	1
M42	320 mm	26 mm	109 mm	WS65	0054 42 320	1
M42	380 mm	26 mm	109 mm	WS65	0054 42 380	5

Notice

ISO 4014 replaces DIN 931 | There is some similarity | Nominal size extended | Width across flats for M10, M12, M14 and M22 changed.