

Design 1:  
with single loop

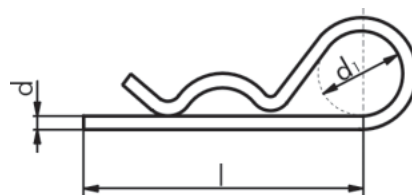

## R-Clip

**Galvanised wire, blue passivated**

- For securing bolts, tubes, struts, etc.
- Simple and rapid to install/remove.
- Reusable.
- Ends are burr-free.

Hole Ø mm	Exterior Ø mm	d mm	l mm	d <sub>1</sub> mm	Wire galv., blue pass. <b>Art. No.</b>	Pack Qty.
2.5	from 9 to 14	2	50	10	<b>0473 2 1</b>	25
3.5	more than 10 to 16	3	56	13	<b>0473 3 1</b>	
4.5	more than 16 to 20	4	60	19	<b>0473 4 1</b>	25/50
6.0	more than 20 to 28	5	85	26	<b>0473 5 1</b>	
7.0	more than 28 to 40	6	105	30	<b>0473 6 1</b>	25
8.0	more than 28 to 45	7	105	30	<b>0473 7 1</b>	10
9.0	more than 30 to 45	8	110	35	<b>0473 8 1</b>	

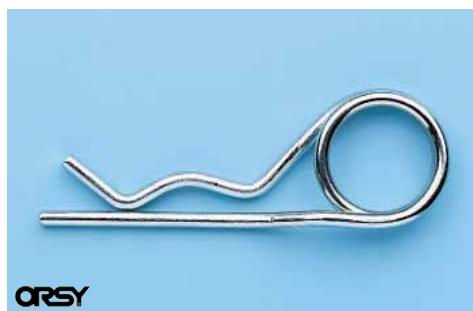

Design 3:  
with double loop

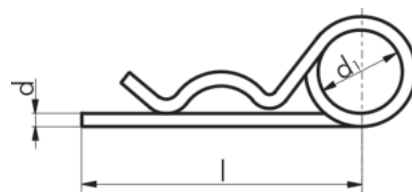

Hole Ø mm	Exterior Ø mm	d mm	l mm	d <sub>1</sub> mm	Wire galv., blue pass. <b>Art. No.</b>	Pack Qty.
2.5	from 8 to 14	2	50	10	<b>0473 2 3</b>	25
3.5	more than 14 to 20	3	62	16	<b>0473 3 3</b>	
4.5	more than 17 to 24	4	78	23	<b>0473 4 3</b>	25/50
6.0	more than 18 to 30	5	92	30	<b>0473 5 3</b>	
7.0	more than 24 to 36	6	120	30	<b>0473 6 3</b>	25
8.0	more than 24 to 45	7	130	30	<b>0473 7 3</b>	10
9.0	more than 24 to 45	8	130	30	<b>0473 8 3</b>	

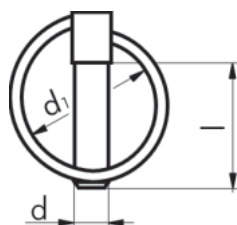

## Linch Pin

**Steel galvanised, yellow passivated**

- With prestressed spring washer.
- For securing bolts, tubes, struts, etc.
- Simple and rapid to install/remove.
- Reusable.

d mm	d <sub>1</sub> mm	l mm	Steel galv., yellow pass. <b>Art. No.</b>	Pack Qty.
4.5	34	42	<b>0472 45</b>	25
5	32	42	<b>0472 5</b>	100
6	41	42	<b>0472 6</b>	25
7.5	41	42	<b>0472 75</b>	100
8	41	42	<b>0472 8</b>	25
9.5	41	42	<b>0472 95</b>	
9.5	41	77	<b>0472 95 77</b>	