

HEXAGONAL BOLT WITH SHANK

ISO 4014 stainless steel A4-50
and A4-70, plain

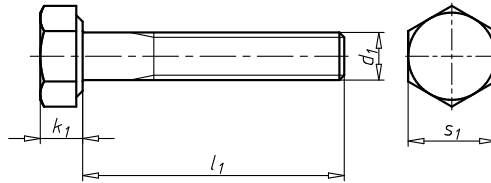

Thread type x nominal diameter (d ₁)	Length (l ₁)	Head height (k ₁)	External drive (s ₁)	Property class	Product class	Art. No.	P. Qty.
M16	60 mm	10 mm	WS24	70	A	0090 16 60	25
M16	65 mm	10 mm	WS24	70	A	0090 16 65	25
M16	70 mm	10 mm	WS24	70	A	0090 16 70	25
M16	75 mm	10 mm	WS24	70	A	0090 16 75	25
M16	80 mm	10 mm	WS24	70	A	0090 16 80	25
M16	85 mm	10 mm	WS24	70	A	0090 16 85	25
M16	90 mm	10 mm	WS24	70	A	0090 16 90	25
M16	95 mm	10 mm	WS24	70	A	0090 16 95	25
M16	100 mm	10 mm	WS21	70	A	0090 16 100	25
M16	110 mm	10 mm	WS24	70	A	0090 16 110	25
M16	120 mm	10 mm	WS24	70	A	0090 16 120	25
M16	130 mm	10 mm	WS24	70	A	0090 16 130	25
M16	140 mm	10 mm	WS24	70	A	0090 16 140	25
M16	150 mm	10 mm	WS24	70	A	0090 16 150	10
M16	160 mm	10 mm	WS24	70	B	0090 16 160	10
M16	170 mm	10 mm	WS24	70	B	0090 16 170	10
M16	180 mm	10 mm	WS24	70	B	0090 16 180	10
M16	190 mm	10 mm	WS24	70	B	0090 16 190	10
M16	200 mm	10 mm	WS24	70	B	0090 16 200	5
M16	220 mm	10 mm	WS24	70	B	0090 16 220	5
M16	230 mm	10 mm	WS24	70	B	0090 16 230	5
M16	240 mm	10 mm	WS24	70	B	0090 16 240	5
M16	250 mm	10 mm	WS24	70	B	0090 16 250	5
M16	260 mm	10 mm	WS24	70	B	0090 16 260	5
M16	280 mm	10 mm	WS24	70	B	0090 16 280	5
M16	300 mm	10 mm	WS24	70	B	0090 16 300	5
M18	80 mm	11.5 mm	WS27	70	A	0090 18 80	25
M18	100 mm	11.5 mm	WS27	70	A	0090 18 100	25
M18	120 mm	11.5 mm	WS27	70	A	0090 18 120	25
M18	130 mm	11.5 mm	WS27	70	A	0090 18 130	10
M18	140 mm	11.5 mm	WS27	70	A	0090 18 140	10
M18	150 mm	11.5 mm	WS27	70	A	0090 18 150	10