

HEXAGONAL BOLT WITH SHANK

ISO 4014 stainless steel A4-50
and A4-70, plain

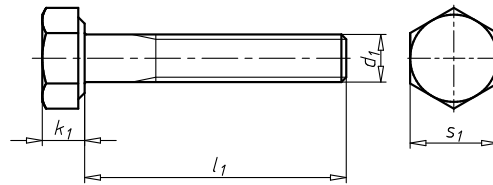

Thread type x nominal diameter (d ₁)	Length (l ₁)	Head height (k ₁)	External drive (s ₁)	Property class	Product class	Art. No.	P. Qty.
M12	50 mm	7.5 mm	WS18	70	A	0090 912 50	100
M12	55 mm	7.5 mm	WS18	70	A	0090 912 55	100
M12	60 mm	7.5 mm	WS18	70	A	0090 912 60	50
M12	65 mm	7.5 mm	WS18	70	A	0090 912 65	25
M12	70 mm	7.5 mm	WS18	70	A	0090 912 70	25
M12	75 mm	7.5 mm	WS18	70	A	0090 912 75	25
M12	80 mm	7.5 mm	WS18	70	A	0090 912 80	25
M12	85 mm	7.5 mm	WS18	70	A	0090 912 85	50
M12	90 mm	7.5 mm	WS18	70	A	0090 912 90	25
M12	95 mm	7.5 mm	WS18	70	A	0090 912 95	50
M12	100 mm	7.5 mm	WS18	70	A	0090 912 100	25
M12	110 mm	7.5 mm	WS18	70	A	0090 912 110	25
M12	120 mm	7.5 mm	WS18	70	A	0090 912 120	25
M12	130 mm	7.5 mm	WS18	70	B	0090 912 130	25
M12	135 mm	7.5 mm	WS18	70	B	0090 912 135	10
M12	140 mm	7.5 mm	WS18	70	B	0090 912 140	25
M12	145 mm	7.5 mm	WS18	70	B	0090 912 145	50
M12	150 mm	7.5 mm	WS18	70	B	0090 912 150	25
M12	160 mm	7.5 mm	WS18	70	B	0090 912 160	50
M12	170 mm	7.5 mm	WS18	70	B	0090 912 170	10
M12	180 mm	7.5 mm	WS18	70	B	0090 912 180	25
M14	60 mm	8.8 mm	WS21	70	A	0090 914 60	25
M14	65 mm	8.8 mm	WS21	70	A	0090 914 65	25
M14	70 mm	8.8 mm	WS21	70	A	0090 914 70	25
M14	90 mm	8.8 mm	WS21	70	A	0090 914 90	25
M14	100 mm	8.8 mm	WS21	70	A	0090 914 100	25
M14	110 mm	8.8 mm	WS21	70	A	0090 914 110	25
M14	120 mm	8.8 mm	WS21	70	A	0090 914 120	25
M14	130 mm	8.8 mm	WS21	70	A	0090 914 130	10
M14	140 mm	8.8 mm	WS21	70	A	0090 914 140	10