

WIT-VM 250, OPTION 1

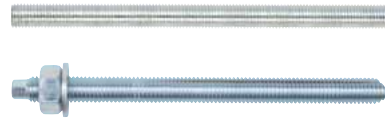

Cracked and uncracked concrete



23.5

2-component reaction resin mortar, vinylester styrene-free

Individual fastening:

Cracked (M12-M30) and uncracked concrete (M8-M30)

WIT-VM 250, coaxial cartridge of 330 ml incl. 1 static mixer

WIT-VM 250, sleeve film cartridge of 300 ml incl. 1 static mixer
for use with normal silicone application gun

Proof of Performance

Approvals

European Technical Approval

Option 1
for cracked (M12-M30) and uncracked concrete (M8-M30)



1. Applications

- Approved for cracked (M12 to M30, concrete tensile zone) and uncracked concrete (M8 to M30, concrete pressure zone), C20/25 to C50/60
- Suitable for securing wooden structures, metal structures, metal profiles, brackets, screens, plumbing objects, pipes, cable conduits etc.

- Injection mortar WIT-VM 250 can also be used for subsequently mortared-in reinforcement attachments
- Injection mortar WIT-VM 250 can also be used for anchors in the masonry (solid and perforated stone) and aerated concrete.

2. Advantages

- Variable anchoring depths
- Hardened injection mortar largely seals off the drill hole
- Cartridge can be used up to expiration of the best before date by replacing the static mixer or by being closed again with sealing cap

Cleaning drilled hole

Clean drill hole: blow out 4x, brush out mechanically 4x, blow out 4x
From M20 and anchoring depth > 240 mm, blow out with oil-free compressed air using the appropriate compressed-air nozzles.

3. Features

- Cracked concrete (M12 to M30) and uncracked concrete (M8 to M30) European Technical Approval ETA-12/0164
- Subsequently mortared-in reinforcement attachments, see Info 29.2 : ETA-12/0166, Z-21.8-2003 (only coaxial cartridge 330 ml)
- 2-component reaction resin mortar, vinylester styrene-free
- Temperature in the anchoring base during processing and hardening: -10 °C to +40 °C
- Ambient temperature after complete hardening -40 °C to +120 °C
- Transport and storage temperature (cartridge): +5 °C to +25 °C
- Shelf life (store in a cool, dry and dark place):
Coaxial cartridge (150 ml, 330ml): 18 months
Hose film cartridge (300ml): 9 months

Setting Instructions

Concrete

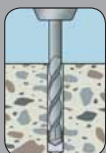

Create drilled hole.

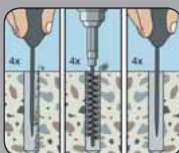

Clean drill hole: blow out 4x, brush out mechanically 4x, blow out 4x, from M20 drilled hole blow out with oil-free compressed air

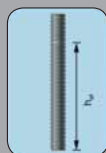

Cut anchor rod to length and mark desired setting depths

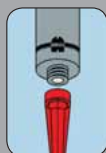

Screw mixer onto cartridge

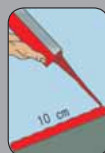

Throw away the initial mortar material (until the mortar is of a uniform color - approx. 10 cm)



Fill composite mortar starting from base of drill hole

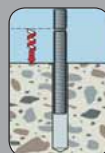

Press in anchor rod up to drill hole base while turning slightly



Visual check of mortar filling quantity, setting depth marking

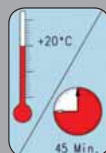

Comply with hardening time of composite mortar



Install component, apply installation torque

Hose film cartridge, 300 ml:
Cut off hose film clip before use!
Initial mortar material approx. 20 cm

