

HEXAGONAL BOLT WITH SHANK

ISO 4014 stainless steel A2-50
and A2-70, plain

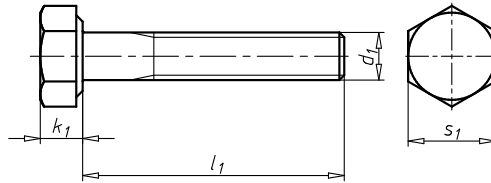

Thread type x nominal diameter (d ₁)	Length (l ₁)	Head height (k ₁)	External drive (s ₁)	Property class	Product class	Art. No.	P. Qty.
M18	60 mm	11.5 mm	WS27	70	A	0095 18 60	25
M18	70 mm	11.5 mm	WS27	70	A	0095 18 70	25
M18	80 mm	11.5 mm	WS27	70	A	0095 18 80	25
M18	90 mm	11.5 mm	WS27	70	A	0095 18 90	25
M18	100 mm	11.5 mm	WS27	70	A	0095 18 100	25
M18	120 mm	11.5 mm	WS27	70	A	0095 18 120	25
M18	130 mm	11.5 mm	WS27	70	A	0095 18 130	10
M18	150 mm	11.5 mm	WS27	70	A	0095 18 150	10
M18	180 mm	11.5 mm	WS27	70	B	0095 18 180	10
M20	60 mm	12.5 mm	WS30	70	A	0095 20 60	25
M20	65 mm	12.5 mm	WS30	70	A	0095 20 65	25
M20	70 mm	12.5 mm	WS30	70	A	0095 20 70	25
M20	75 mm	12.5 mm	WS30	70	A	0095 20 75	25
M20	80 mm	12.5 mm	WS30	70	A	0095 20 80	25
M20	85 mm	12.5 mm	WS30	70	A	0095 20 85	25
M20	90 mm	12.5 mm	WS30	70	A	0095 20 90	25
M20	95 mm	12.5 mm	WS30	70	A	0095 20 95	25
M20	100 mm	12.5 mm	WS30	70	A	0095 20 100	25
M20	110 mm	12.5 mm	WS30	70	A	0095 20 110	10
M20	120 mm	12.5 mm	WS30	70	A	0095 20 120	10
M20	130 mm	12.5 mm	WS30	70	A	0095 20 130	10
M20	140 mm	12.5 mm	WS30	70	A	0095 20 140	10
M20	150 mm	12.5 mm	WS30	70	A	0095 20 150	10
M20	160 mm	12.5 mm	WS30	70	B	0095 20 160	10
M20	170 mm	12.5 mm	WS30	70	B	0095 20 170	10
M20	180 mm	12.5 mm	WS30	70	B	0095 20 180	10
M20	190 mm	12.5 mm	WS30	70	B	0095 20 190	10
M20	200 mm	12.5 mm	WS30	70	B	0095 20 200	10
M20	220 mm	12.5 mm	WS30	70	B	0095 20 220	10
M20	240 mm	12.5 mm	WS30	70	B	0095 20 240	10
M20	250 mm	12.5 mm	WS30	70	B	0095 20 250	10
M22	90 mm	14 mm	WS34	70	A	0095 922 90	25
M22	100 mm	14 mm	WS34	70	A	0095 922 100	25
M22	110 mm	14 mm	WS34	70	A	0095 922 110	25
M22	120 mm	14 mm	WS34	70	A	0095 922 120	25
M22	130 mm	14 mm	WS34	70	A	0095 922 130	25
M22	140 mm	14 mm	WS34	70	A	0095 922 140	25
M22	150 mm	14 mm	WS34	70	A	0095 922 150	10
M22	160 mm	14 mm	WS34	70	B	0095 922 160	10
M22	180 mm	14 mm	WS34	70	B	0095 922 180	10
M22	200 mm	14 mm	WS34	70	B	0095 922 200	10
M22	220 mm	14 mm	WS34	70	B	0095 922 220	10