

HEXAGONAL BOLT WITH SHANK

ISO 4014 stainless steel A2-50
and A2-70, plain

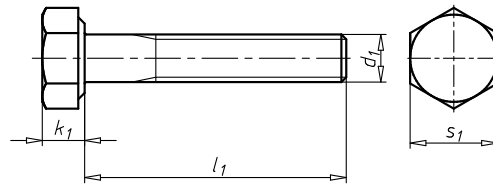

Thread type x nominal diameter (d ₁)	Length (l ₁)	Head height (k ₁)	External drive (s ₁)	Property class	Product class	Art. No.	P. Qty.
M10	45 mm	6.4 mm	WS16	70	A	0095 910 45	100
M10	50 mm	6.4 mm	WS16	70	A	0095 910 50	100
M10	55 mm	6.4 mm	WS16	70	A	0095 910 55	100
M10	60 mm	6.4 mm	WS16	70	A	0095 910 60	50
M10	65 mm	6.4 mm	WS16	70	A	0095 910 65	50
M10	70 mm	6.4 mm	WS16	70	A	0095 910 70	50
M10	75 mm	6.4 mm	WS16	70	A	0095 910 75	50
M10	80 mm	6.4 mm	WS16	70	A	0095 910 80	50
M10	85 mm	6.4 mm	WS16	70	A	0095 910 85	100
M10	90 mm	6.4 mm	WS16	70	A	0095 910 90	50
M10	100 mm	6.4 mm	WS16	70	A	0095 910 100	50
M10	110 mm	6.4 mm	WS16	70	B	0095 910 110	25
M10	120 mm	6.4 mm	WS16	70	B	0095 910 120	25
M10	130 mm	6.4 mm	WS16	70	B	0095 910 130	25
M10	140 mm	6.4 mm	WS16	70	B	0095 910 140	25
M10	150 mm	6.4 mm	WS16	70	B	0095 910 150	25
M10	160 mm	6.4 mm	WS16	70	B	0095 910 160	25
M10	165 mm	6.4 mm	WS16	70	B	0095 910 165	100
M10	170 mm	6.4 mm	WS16	70	B	0095 910 170	25
M10	180 mm	6.4 mm	WS16	70	B	0095 910 180	25
M10	190 mm	6.4 mm	WS16	70	B	0095 910 190	25
M10	200 mm	6.4 mm	WS16	70	B	0095 910 200	25
M12	50 mm	7.5 mm	WS18	70	A	0095 912 50	100
M12	55 mm	7.5 mm	WS18	70	A	0095 912 55	100
M12	60 mm	7.5 mm	WS18	70	A	0095 912 60	50
M12	65 mm	7.5 mm	WS18	70	A	0095 912 65	50
M12	70 mm	7.5 mm	WS18	70	A	0095 912 70	25
M12	75 mm	7.5 mm	WS18	70	A	0095 912 75	25
M12	80 mm	7.5 mm	WS18	70	A	0095 912 80	25
M12	90 mm	7.5 mm	WS18	70	A	0095 912 90	25
M12	100 mm	7.5 mm	WS18	70	A	0095 912 100	25
M12	110 mm	7.5 mm	WS18	70	A	0095 912 110	25
M12	120 mm	7.5 mm	WS18	70	A	0095 912 120	25
M12	130 mm	7.5 mm	WS18	70	B	0095 912 130	25
M12	140 mm	7.5 mm	WS18	70	B	0095 912 140	25
M12	150 mm	7.5 mm	WS18	70	B	0095 912 150	25
M12	160 mm	7.5 mm	WS18	70	B	0095 912 160	25
M12	170 mm	7.5 mm	WS18	70	B	0095 912 170	25
M12	180 mm	7.5 mm	WS18	70	B	0095 912 180	25
M12	200 mm	7.5 mm	WS18	70	B	0095 912 200	25