

## HSS CORE DRILL BIT ASSORTMENT

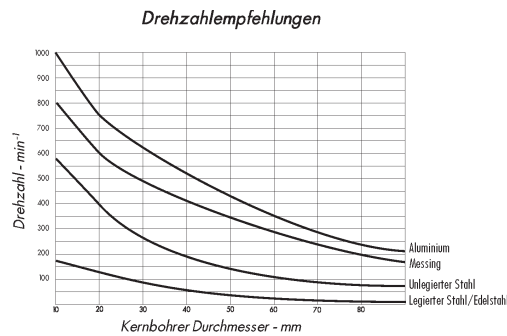
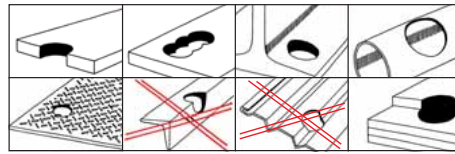

**7 pieces. With weld-on shank Ø 19 mm. For use on mobile magnetic core drills or stationary drills for producing large holes up to Ø 50 mm and a max. cutting depth of 50 mm. Fits most standard magnetic drills.**

**High performance and rapid drilling progress with a long service life**

In contrast to solid drilling, only a thin metal ring is cut. The drill core is ejected by an ejector pin.

**No pre-drilling required, no formation of burrs**

No pre- or post-processing required

**Optimised cutting geometry**

- Long service life compared to many standard core drill bits
- Clean drill profile
- Drill hole with precise tolerances

**Precise guidance, no slipping**

Suitable for overlap drilling. Problem-free drilling on curved surfaces and pipes.

<b>Art. No.</b>	<b>0630 930</b>
<b>P. Qty.</b>	1
<b>Cutting depth</b>	30 mm
<b>Length</b>	63 mm
<b>Number of pieces in assortment/set</b>	7 PCS

Contents for Art. No.	Designation	Art. No.	Number
<b>0630 930</b>	Ejector pin	<b>0630 930 001</b>	1
	Core drill bit HSS 12 mm	<b>0630 930 120</b>	1
	Core drill bit HSS 14 mm	<b>0630 930 140</b>	1
	Core drill bit HSS 16 mm	<b>0630 930 160</b>	1
	Core drill bit HSS 18 mm	<b>0630 930 180</b>	1
	Core drill bit HSS 20 mm	<b>0630 930 200</b>	1
	Core drill bit HSS 22 mm	<b>0630 930 220</b>	1

### Application area

Stainless steel, cast iron, wood, sandwich materials, wood with nails. Particularly suitable for steel, thin sheet metal, non-ferrous metals and plastics.

### Notice

- Ensuring that there is sufficient cooling/lubrication significantly extends the service life. Do not use in a dry state.
- Unsuitable for pressboard and alloyed steels

## HOLDER, HSS CORE DRILL BIT



**For using the core drill bit on machines with morse taper mounts**

Morse taper size	Lubrication	Art. No.	P. Qty.
MK 2	Automatic	<b>0630 930 003</b>	1
MK 2	Manual	<b>0630 930 002</b>	1
MK 3	Automatic	<b>0630 930 005</b>	1
MK 3	Manual	<b>0630 930 004</b>	1