

FLAT WASHER WITH CHAMFER FOR HIGH-STRENGTH FITTINGS

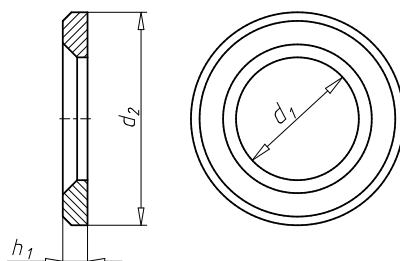

Hot-dip galvanised steel, hardness 300 HV to 370 HV. High-strength screw connections preloaded for metal construction according to DIN EN 14399-6.

Notice

„Only use complete sets (screws, nuts and washers) from one manufacturer.“
(Extract from DIN EN 1993-1-8/NA:2010-12)

The design of steel structures with high-tensile pre-stressed fittings is regulated in standards DIN EN 1090-2 and DIN EN 1993-1-8/NA.

Storage and transport:

The screws, nuts and washers are supplied in a hot-dip galvanised design with nut lubricated under process conditions. The female thread of the nut is not hot-dip galvanised and is only protected from corrosion by the applied lubrication. Improper storage or transport conditions may cause corrosion of the female thread or a change in the condition of the factory-supplied lubrication, thus changing the relationship between tightening torque and pre-tension force.

Norms	EN 14399-6
Material	Steel
Min./max. Vickers hardness, HV	300-370 HV
Surface	Hot-dip galvanised
Area of application	Steel construction
Suitable for	High-strength friction connections in steel structures
Construction product	Yes
Declaration of performance (EU-CPR)	Yes
RoHS-compliant	Yes

Suitable for screw thread	Internal diameter (d ₁)	Outer diameter (d ₂)	Thickness (h ₁)	Art. No.	P. Qty.
M12	13 mm	24 mm	3 mm	0079 06 12	1/400
M16	17 mm	30 mm	4 mm	0079 06 16	1/200
M20	21 mm	37 mm	4 mm	0079 06 20	1/200
M22	23 mm	39 mm	4 mm	0079 06 22	1/200
M24	25 mm	44 mm	4 mm	0079 06 24	1/200
M27	28 mm	50 mm	5 mm	0079 06 27	1/100
M30	31 mm	56 mm	5 mm	0079 06 30	1/100
M36	37 mm	66 mm	6 mm	0079 06 36	1/50

Application area

Washers in accordance with this standard are intended for high-strength fittings in accordance with DIN EN 14399-4