

Hexagonal bolt with thread up to the head

ISO 4017 stainless steel A4-50 and A4-70, plain

Standards	ISO 4017
Material	Stainless steel A4
Surface	Plain
RoHS-compliant	Yes

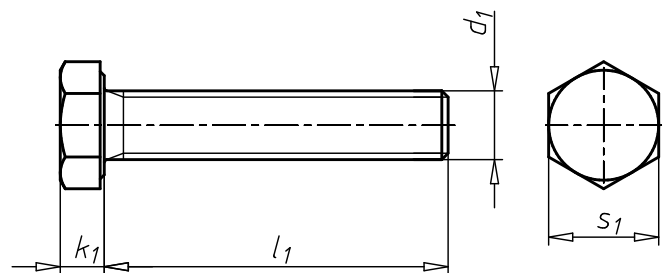

Thread type x nominal diameter (d ₁)	Length (l ₁)	Head height (k ₁)	External drive (s ₁)	Property class	Art. no.	P. Qty.
M2.5	6 mm	1.7 mm	WS5	70	0091 925 6	1000
M2.5	8 mm	1.7 mm	WS5	70	0091 925 8	1000
M3	5 mm	2 mm	WS5.5	70	0091 3 5	1000
M3	6 mm	2 mm	WS5.5	70	0091 3 6	1000
M3	8 mm	2 mm	WS5.5	70	0091 3 8	1000
M3	10 mm	2 mm	WS5.5	70	0091 3 10	1000
M3	12 mm	2 mm	WS5.5	70	0091 3 12	1000
M3	14 mm	2 mm	WS5.5	70	0091 3 14	1000
M3	16 mm	2 mm	WS5.5	70	0091 3 16	1000
M3	20 mm	2 mm	WS5.5	70	0091 3 20	1000
M3	25 mm	2 mm	WS5.5	70	0091 3 25	500
M3	30 mm	2 mm	WS5.5	70	0091 3 30	500
M3	35 mm	2 mm	WS5.5	70	0091 3 35	500
M3	40 mm	2 mm	WS5.5	70	0091 3 40	500
M4	6 mm	2.8 mm	WS7	70	0091 4 6	200
M4	8 mm	2.8 mm	WS7	70	0091 4 8	200
M4	10 mm	2.8 mm	WS7	70	0091 4 10	200
M4	12 mm	2.8 mm	WS7	70	0091 4 12	200
M4	14 mm	2.8 mm	WS7	70	0091 4 14	200
M4	16 mm	2.8 mm	WS7	70	0091 4 16	200
M4	18 mm	2.8 mm	WS7	70	0091 4 18	200
M4	20 mm	2.8 mm	WS7	70	0091 4 20	200
M4	25 mm	2.8 mm	WS7	70	0091 4 25	200
M4	30 mm	2.8 mm	WS7	70	0091 4 30	200
M4	35 mm	2.8 mm	WS7	70	0091 4 35	200
M4	40 mm	2.8 mm	WS7	70	0091 4 40	200
M4	45 mm	2.8 mm	WS7	70	0091 4 45	200
M4	50 mm	2.8 mm	WS7	70	0091 4 50	200

Thread type x nominal diameter (d ₁)	Length (l ₁)	Head height (k ₁)	External drive (s ₁)	Property class	Art. no.	P. Qty.
M4	60 mm	2.8 mm	WS7	70	0091 4 60	200
M4	70 mm	2.8 mm	WS7	70	0091 4 70	200
M5	6 mm	3.5 mm	WS8	70	0091 5 6	500
M5	8 mm	3.5 mm	WS8	70	0091 5 8	100
M5	10 mm	3.5 mm	WS8	70	0091 5 10	100
M5	12 mm	3.5 mm	WS8	70	0091 5 12	100
M5	14 mm	3.5 mm	WS8	70	0091 5 14	100
M5	16 mm	3.5 mm	WS8	70	0091 5 16	100
M5	18 mm	3.5 mm	WS8	70	0091 5 18	100
M5	20 mm	3.5 mm	WS8	70	0091 5 20	100
M5	25 mm	3.5 mm	WS8	70	0091 5 25	100
M5	30 mm	3.5 mm	WS8	70	0091 5 30	100
M5	35 mm	3.5 mm	WS8	70	0091 5 35	100
M5	40 mm	3.5 mm	WS8	70	0091 5 40	100
M5	45 mm	3.5 mm	WS8	70	0091 5 45	100
M5	50 mm	3.5 mm	WS8	70	0091 5 50	100
M5	55 mm	3.5 mm	WS8	70	0091 5 55	100
M5	60 mm	3.5 mm	WS8	70	0091 5 60	100
M5	65 mm	3.5 mm	WS8	70	0091 5 65	100
M5	70 mm	3.5 mm	WS8	70	0091 5 70	100
M5	80 mm	3.5 mm	WS8	70	0091 5 80	100
M6	6 mm	4 mm	WS10	70	0091 6 6	200
M6	8 mm	4 mm	WS10	70	0091 6 8	100
M6	10 mm	4 mm	WS10	70	0091 6 10	100
M6	12 mm	4 mm	WS10	70	0091 6 12	100
M6	14 mm	4 mm	WS10	70	0091 6 14	100
M6	16 mm	4 mm	WS10	70	0091 6 16	100
M6	18 mm	4 mm	WS10	70	0091 6 18	100
M6	20 mm	4 mm	WS10	70	0091 6 20	100
M6	22 mm	4 mm	WS10	70	0091 6 22	100
M6	25 mm	4 mm	WS10	70	0091 6 25	100
M6	30 mm	4 mm	WS10	70	0091 6 30	100
M6	35 mm	4 mm	WS10	70	0091 6 35	100
M6	40 mm	4 mm	WS10	70	0091 6 40	100
M6	45 mm	4 mm	WS10	70	0091 6 45	100
M6	50 mm	4 mm	WS10	70	0091 6 50	100
M6	55 mm	4 mm	WS10	70	0091 6 55	100
M6	60 mm	4 mm	WS10	70	0091 6 60	100
M6	65 mm	4 mm	WS10	70	0091 6 65	100
M6	70 mm	4 mm	WS10	70	0091 6 70	100
M6	75 mm	4 mm	WS10	70	0091 6 75	100
M6	80 mm	4 mm	WS10	70	0091 6 80	100
M6	90 mm	4 mm	WS10	70	0091 6 90	100
M6	100 mm	4 mm	WS10	70	0091 6 100	100
M6	120 mm	4 mm	WS10	70	0091 6 120	100
M8	10 mm	5.3 mm	WS13	70	0091 8 10	100
M8	12 mm	5.3 mm	WS13	70	0091 8 12	200
M8	14 mm	5.3 mm	WS13	70	0091 8 14	100
M8	16 mm	5.3 mm	WS13	70	0091 8 16	100
M8	18 mm	5.3 mm	WS13	70	0091 8 18	100
M8	20 mm	5.3 mm	WS13	70	0091 8 20	100
M8	22 mm	5.3 mm	WS13	70	0091 8 22	200
M8	25 mm	5.3 mm	WS13	70	0091 8 25	100

C101_3511110832_Rev: 0.299, Staler: 06.02.2023

Thread type x nominal diameter (d ₁)	Length (l ₁)	Head height (k ₁)	External drive (s ₁)	Property class	Art. no.	P. Qty.
M8	30 mm	5.3 mm	WS13	70	0091 8 30	100
M8	35 mm	5.3 mm	WS13	70	0091 8 35	100
M8	40 mm	5.3 mm	WS13	70	0091 8 40	100
M8	45 mm	5.3 mm	WS13	70	0091 8 45	100
M8	50 mm	5.3 mm	WS13	70	0091 8 50	100
M8	55 mm	5.3 mm	WS13	70	0091 8 55	100
M8	60 mm	5.3 mm	WS13	70	0091 8 60	100
M8	65 mm	5.3 mm	WS13	70	0091 8 65	100
M8	70 mm	5.3 mm	WS13	70	0091 8 70	50
M8	75 mm	5.3 mm	WS13	70	0091 8 75	50
M8	80 mm	5.3 mm	WS13	70	0091 8 80	50
M8	85 mm	5.3 mm	WS13	70	0091 8 85	50
M8	90 mm	5.3 mm	WS13	70	0091 8 90	50
M8	100 mm	5.3 mm	WS13	70	0091 8 100	50
M8	110 mm	5.3 mm	WS13	70	0091 8 110	50
M8	120 mm	5.3 mm	WS13	70	0091 8 120	50
M8	130 mm	5.3 mm	WS13	70	0091 8 130	50
M8	140 mm	5.3 mm	WS13	70	0091 8 140	50
M8	150 mm	5.3 mm	WS13	70	0091 8 150	50
M8	160 mm	5.3 mm	WS13	70	0091 8 160	50
M8	170 mm	5.3 mm	WS13	70	0091 8 170	50
M8	180 mm	5.3 mm	WS13	70	0091 8 180	50
M8	190 mm	5.3 mm	WS13	70	0091 8 190	50
M8	200 mm	5.3 mm	WS13	70	0091 8 200	50
M10	16 mm	6.4 mm	WS16	70	0091 910 16	100
M10	18 mm	6.4 mm	WS16	70	0091 910 18	100
M10	20 mm	6.4 mm	WS16	70	0091 910 20	100
M10	25 mm	6.4 mm	WS16	70	0091 910 25	100
M10	30 mm	6.4 mm	WS16	70	0091 910 30	100
M10	35 mm	6.4 mm	WS16	70	0091 910 35	100
M10	40 mm	6.4 mm	WS16	70	0091 910 40	100
M10	45 mm	6.4 mm	WS16	70	0091 910 45	100
M10	50 mm	6.4 mm	WS16	70	0091 910 50	100
M10	55 mm	6.4 mm	WS16	70	0091 910 55	50
M10	60 mm	6.4 mm	WS16	70	0091 910 60	50
M10	65 mm	6.4 mm	WS16	70	0091 910 65	50
M10	70 mm	6.4 mm	WS16	70	0091 910 70	50
M10	80 mm	6.4 mm	WS16	70	0091 910 80	50
M10	90 mm	6.4 mm	WS16	70	0091 910 90	25
M10	100 mm	6.4 mm	WS16	70	0091 910 100	25
M10	110 mm	6.4 mm	WS16	70	0091 910 110	50
M10	120 mm	6.4 mm	WS16	70	0091 910 120	100
M10	130 mm	6.4 mm	WS16	70	0091 910 130	50
M10	140 mm	6.4 mm	WS16	70	0091 910 140	50
M10	150 mm	6.4 mm	WS16	70	0091 910 150	50
M12	20 mm	7.5 mm	WS18	70	0091 912 20	100
M12	25 mm	7.5 mm	WS18	70	0091 912 25	100
M12	30 mm	7.5 mm	WS18	70	0091 912 30	100
M12	35 mm	7.5 mm	WS18	70	0091 912 35	100
M12	40 mm	7.5 mm	WS18	70	0091 912 40	100
M12	45 mm	7.5 mm	WS18	70	0091 912 45	100
M12	50 mm	7.5 mm	WS18	70	0091 912 50	100
M12	55 mm	7.5 mm	WS18	70	0091 912 55	100

Thread type x nominal diameter (d ₁)	Length (l ₁)	Head height (k ₁)	External drive (s ₁)	Property class	Art. no.	P. Qty.
M12	60 mm	7.5 mm	WS18	70	0091 912 60	50
M12	65 mm	7.5 mm	WS18	70	0091 912 65	50
M12	70 mm	7.5 mm	WS18	70	0091 912 70	25
M12	75 mm	7.5 mm	WS18	70	0091 912 75	25
M12	80 mm	7.5 mm	WS18	70	0091 912 80	25
M12	85 mm	7.5 mm	WS18	70	0091 912 85	25
M12	90 mm	7.5 mm	WS18	70	0091 912 90	25
M12	100 mm	7.5 mm	WS18	70	0091 912 100	25
M12	110 mm	7.5 mm	WS18	70	0091 912 110	25
M12	120 mm	7.5 mm	WS18	70	0091 912 120	25
M12	130 mm	7.5 mm	WS18	70	0091 912 130	25
M12	150 mm	7.5 mm	WS18	70	0091 912 150	50
M14	30 mm	8.8 mm	WS21	70	0091 914 30	25
M14	35 mm	8.8 mm	WS21	70	0091 914 35	25
M14	40 mm	8.8 mm	WS21	70	0091 914 40	25
M14	45 mm	8.8 mm	WS21	70	0091 914 45	25
M14	50 mm	8.8 mm	WS21	70	0091 914 50	25
M14	55 mm	8.8 mm	WS21	70	0091 914 55	25
M14	60 mm	8.8 mm	WS21	70	0091 914 60	25
M14	65 mm	8.8 mm	WS21	70	0091 914 65	25
M14	70 mm	8.8 mm	WS21	70	0091 914 70	25
M14	80 mm	8.8 mm	WS21	70	0091 914 80	25
M14	90 mm	8.8 mm	WS21	70	0091 914 90	25
M14	100 mm	8.8 mm	WS21	70	0091 914 100	25
M14	110 mm	8.8 mm	WS21	70	0091 914 110	25
M14	120 mm	8.8 mm	WS21	70	0091 914 120	25
M14	130 mm	8.8 mm	WS21	70	0091 914 130	25
M14	140 mm	8.8 mm	WS21	70	0091 914 140	25
M16	16 mm	10 mm	WS24	70	0091 16 16	50
M16	20 mm	10 mm	WS24	70	0091 16 20	50
M16	25 mm	10 mm	WS24	70	0091 16 25	50
M16	30 mm	10 mm	WS24	70	0091 16 30	50
M16	35 mm	10 mm	WS24	70	0091 16 35	50
M16	40 mm	10 mm	WS24	70	0091 16 40	50
M16	45 mm	10 mm	WS24	70	0091 16 45	25
M16	50 mm	10 mm	WS24	70	0091 16 50	25
M16	55 mm	10 mm	WS24	70	0091 16 55	25
M16	60 mm	10 mm	WS24	70	0091 16 60	25
M16	65 mm	10 mm	WS24	70	0091 16 65	25
M16	70 mm	10 mm	WS24	70	0091 16 70	25
M16	75 mm	10 mm	WS24	70	0091 16 75	25
M16	80 mm	10 mm	WS24	70	0091 16 80	25
M16	90 mm	10 mm	WS24	70	0091 16 90	25
M16	100 mm	10 mm	WS24	70	0091 16 100	25
M16	110 mm	10 mm	WS24	70	0091 16 110	25
M16	120 mm	10 mm	WS24	70	0091 16 120	25
M16	130 mm	10 mm	WS24	70	0091 16 130	25
M16	140 mm	10 mm	WS24	70	0091 16 140	25
M16	150 mm	10 mm	WS24	70	0091 16 150	10
M16	160 mm	10 mm	WS24	70	0091 16 160	10
M16	170 mm	10 mm	WS24	70	0091 16 170	10
M16	180 mm	10 mm	WS24	70	0091 16 180	10
M16	190 mm	10 mm	WS24	70	0091 16 190	5

Thread type x nominal diameter (d ₁)	Length (l ₁)	Head height (k ₁)	External drive (s ₁)	Property class	Art. no.	P. Qty.
M16	200 mm	10 mm	WS24	70	0091 16 200	5
M18	30 mm	11.5 mm	WS27	70	0091 18 30	25
M18	35 mm	11.5 mm	WS27	70	0091 18 35	25
M18	40 mm	11.5 mm	WS27	70	0091 18 40	25
M18	45 mm	11.5 mm	WS27	70	0091 18 45	25
M18	50 mm	11.5 mm	WS27	70	0091 18 50	50
M18	55 mm	11.5 mm	WS27	70	0091 18 55	25
M18	60 mm	11.5 mm	WS27	70	0091 18 60	25
M18	65 mm	11.5 mm	WS27	70	0091 18 65	25
M18	70 mm	11.5 mm	WS27	70	0091 18 70	25
M18	75 mm	11.5 mm	WS27	70	0091 18 75	25
M18	80 mm	11.5 mm	WS27	70	0091 18 80	25
M18	90 mm	11.5 mm	WS27	70	0091 18 90	25
M18	100 mm	11.5 mm	WS27	70	0091 18 100	25
M18	110 mm	11.5 mm	WS27	70	0091 18 110	25
M18	120 mm	11.5 mm	WS27	70	0091 18 120	10
M18	150 mm	11.5 mm	WS27	70	0091 18 150	10
M20	25 mm	12.5 mm	WS30	70	0091 20 25	25
M20	30 mm	12.5 mm	WS30	70	0091 20 30	25
M20	35 mm	12.5 mm	WS30	70	0091 20 35	50
M20	40 mm	12.5 mm	WS30	70	0091 20 40	25
M20	45 mm	12.5 mm	WS30	70	0091 20 45	25
M20	50 mm	12.5 mm	WS30	70	0091 20 50	25
M20	55 mm	12.5 mm	WS30	70	0091 20 55	25
M20	60 mm	12.5 mm	WS30	70	0091 20 60	25
M20	65 mm	12.5 mm	WS30	70	0091 20 65	25
M20	70 mm	12.5 mm	WS30	70	0091 20 70	25
M20	75 mm	12.5 mm	WS30	70	0091 20 75	25
M20	80 mm	12.5 mm	WS30	70	0091 20 80	25
M20	85 mm	12.5 mm	WS30	70	0091 20 85	25
M20	90 mm	12.5 mm	WS30	70	0091 20 90	25
M20	100 mm	12.5 mm	WS30	70	0091 20 100	10
M20	110 mm	12.5 mm	WS30	70	0091 20 110	25
M20	120 mm	12.5 mm	WS30	70	0091 20 120	10
M20	130 mm	12.5 mm	WS30	70	0091 20 130	25
M20	140 mm	12.5 mm	WS30	70	0091 20 140	10
M20	150 mm	12.5 mm	WS30	70	0091 20 150	10
M20	160 mm	12.5 mm	WS30	70	0091 20 160	10
M20	170 mm	12.5 mm	WS30	70	0091 20 170	10
M20	180 mm	12.5 mm	WS30	70	0091 20 180	10
M20	190 mm	12.5 mm	WS30	70	0091 20 190	10
M20	200 mm	12.5 mm	WS30	70	0091 20 200	10
M22	45 mm	14 mm	WS34	70	0091 922 45	10
M22	50 mm	14 mm	WS34	70	0091 922 50	10
M22	55 mm	14 mm	WS34	70	0091 922 55	10
M22	60 mm	14 mm	WS34	70	0091 922 60	10
M22	65 mm	14 mm	WS34	70	0091 922 65	10
M22	70 mm	14 mm	WS34	70	0091 922 70	10
M22	80 mm	14 mm	WS34	70	0091 922 80	10
M22	90 mm	14 mm	WS34	70	0091 922 90	10
M22	100 mm	14 mm	WS34	70	0091 922 100	10
M22	110 mm	14 mm	WS34	70	0091 922 110	10
M22	120 mm	14 mm	WS34	70	0091 922 120	10

Thread type x nominal diameter (d ₁)	Length (l ₁)	Head height (k ₁)	External drive (s ₁)	Property class	Art. no.	P. Qty.
M22	130 mm	14 mm	WS34	70	0091 922 130	10
M22	140 mm	14 mm	WS34	70	0091 922 140	10
M22	150 mm	14 mm	WS34	70	0091 922 150	10
M24	40 mm	15 mm	WS36	70	0091 24 40	10
M24	45 mm	15 mm	WS36	70	0091 24 45	10
M24	50 mm	15 mm	WS36	70	0091 24 50	10
M24	55 mm	15 mm	WS36	70	0091 24 55	10
M24	60 mm	15 mm	WS36	70	0091 24 60	10
M24	65 mm	15 mm	WS36	70	0091 24 65	10
M24	70 mm	15 mm	WS36	70	0091 24 70	10
M24	75 mm	15 mm	WS36	70	0091 24 75	10
M24	80 mm	15 mm	WS36	70	0091 24 80	10
M24	90 mm	15 mm	WS36	70	0091 24 90	10
M24	100 mm	15 mm	WS36	70	0091 24 100	5
M24	110 mm	15 mm	WS36	70	0091 24 110	10
M24	120 mm	15 mm	WS36	70	0091 24 120	20
M24	130 mm	15 mm	WS36	70	0091 24 130	10
M24	140 mm	15 mm	WS36	70	0091 24 140	10
M24	150 mm	15 mm	WS36	70	0091 24 150	10
M24	160 mm	15 mm	WS36	70	0091 24 160	10
M24	180 mm	15 mm	WS36	70	0091 24 180	5
M24	190 mm	15 mm	WS36	70	0091 24 190	5
M24	200 mm	15 mm	WS36	70	0091 24 200	10
M27	50 mm	17 mm	WS41	50	0091 27 50	5
M27	60 mm	17 mm	WS41	50	0091 27 60	5
M27	65 mm	17 mm	WS41	50	0091 27 65	5
M27	70 mm	17 mm	WS41	50	0091 27 70	5
M27	80 mm	17 mm	WS41	50	0091 27 80	10
M27	90 mm	17 mm	WS41	50	0091 27 90	5
M27	110 mm	17 mm	WS41	50	0091 27 110	5
M27	120 mm	17 mm	WS41	50	0091 27 120	10
M27	130 mm	17 mm	WS41	50	0091 27 130	5
M27	140 mm	17 mm	WS41	50	0091 27 140	5
M27	150 mm	17 mm	WS41	50	0091 27 150	5
M30	50 mm	18.7 mm	WS46	50	0091 30 50	1
M30	55 mm	18.7 mm	WS46	50	0091 30 55	1
M30	60 mm	18.7 mm	WS46	50	0091 30 60	1
M30	70 mm	18.7 mm	WS46	50	0091 30 70	10
M30	75 mm	18.7 mm	WS46	50	0091 30 75	1
M30	80 mm	18.7 mm	WS46	50	0091 30 80	1
M30	90 mm	18.7 mm	WS46	50	0091 30 90	1
M30	100 mm	18.7 mm	WS46	50	0091 30 100	1
M30	110 mm	18.7 mm	WS46	50	0091 30 110	1
M30	120 mm	18.7 mm	WS46	50	0091 30 120	1
M30	130 mm	18.7 mm	WS46	50	0091 30 130	10
M30	150 mm	18.7 mm	WS46	50	0091 30 150	1
M36	90 mm	22.5 mm	WS55	50	0091 36 90	1
M36	100 mm	22.5 mm	WS55	50	0091 36 100	1
M36	110 mm	22.5 mm	WS55	50	0091 36 110	1
M36	120 mm	22.5 mm	WS55	50	0091 36 120	1
M36	130 mm	22.5 mm	WS55	50	0091 36 130	10
M36	140 mm	22.5 mm	WS55	50	0091 36 140	1
M36	150 mm	22.5 mm	WS55	50	0091 36 150	1

Thread type x nominal diameter (d ₁)	Length (l ₁)	Head height (k ₁)	External drive (s ₁)	Property class	Art. no.	P. Qty.
M36	160 mm	22.5 mm	WS55	50	0091 36 160	1

Notice

ISO 4017 replaces DIN 933 | There is some compatibility | Nominal size extended | Widths across flats for M10, M12, M14 and M22 changed. Strength A4-70 up to and including nominal size M24 | From nominal size M27 strength A4-50