

Hexagonal bolt with shank

ISO 4014, steel 8.8, plain

Standards	ISO 4014
Material	Steel
Property class	8.8
Surface	Plain
RoHS-compliant	Yes

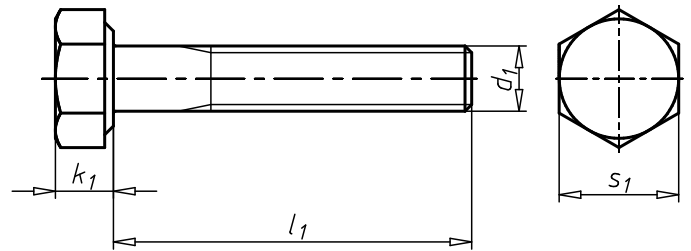

Thread type x nominal diameter (d ₁)	Length (l ₁)	Head height (k ₁)	Thread length (metric thread) (b)	External drive (s ₁)	Art. no.	P. Qty.
M3	30 mm	2 mm	12 mm	WS5.5	0051 3 30	100
M3	35 mm	2 mm	12 mm	WS5.5	0051 3 35	500
M3	40 mm	2 mm	12 mm	WS5.5	0051 3 40	500
M4	25 mm	2.8 mm	14 mm	WS7	0051 4 25	1000
M4	30 mm	2.8 mm	14 mm	WS7	0051 4 30	500
M4	35 mm	2.8 mm	14 mm	WS7	0051 4 35	500
M4	40 mm	2.8 mm	14 mm	WS7	0051 4 40	100
M4	45 mm	2.8 mm	14 mm	WS7	0051 4 45	500
M4	50 mm	2.8 mm	14 mm	WS7	0051 4 50	500
M4	55 mm	2.8 mm	14 mm	WS7	0051 4 55	200
M4	60 mm	2.8 mm	14 mm	WS7	0051 4 60	200
M4	65 mm	2.8 mm	14 mm	WS7	0051 4 65	100
M4	70 mm	2.8 mm	14 mm	WS7	0051 4 70	200
M4	80 mm	2.8 mm	14 mm	WS7	0051 4 80	100
M5	25 mm	3.5 mm	16 mm	WS8	0051 5 25	500
M5	30 mm	3.5 mm	16 mm	WS8	0051 5 30	500
M5	35 mm	3.5 mm	16 mm	WS8	0051 5 35	200
M5	40 mm	3.5 mm	16 mm	WS8	0051 5 40	200
M5	45 mm	3.5 mm	16 mm	WS8	0051 5 45	500
M5	50 mm	3.5 mm	16 mm	WS8	0051 5 50	200
M5	55 mm	3.5 mm	16 mm	WS8	0051 5 55	500
M5	65 mm	3.5 mm	16 mm	WS8	0051 5 65	200
M5	70 mm	3.5 mm	16 mm	WS8	0051 5 70	200
M5	75 mm	3.5 mm	16 mm	WS8	0051 5 75	200
M5	80 mm	3.5 mm	16 mm	WS8	0051 5 80	200
M5	85 mm	3.5 mm	16 mm	WS8	0051 5 85	100
M5	90 mm	3.5 mm	16 mm	WS8	0051 5 90	200
M5	100 mm	3.5 mm	16 mm	WS8	0051 5 100	200
M5	110 mm	3.5 mm	16 mm	WS8	0051 5 110	100
M5	115 mm	3.5 mm	16 mm	WS8	0051 5 115	50
M5	120 mm	3.5 mm	16 mm	WS8	0051 5 120	100
M5	130 mm	3.5 mm	22 mm	WS8	0051 5 130	100

Thread type x nominal diameter (d ₁)	Length (l ₁)	Head height (k ₁)	Thread length (metric thread) (b)	External drive (s ₁)	Art. no.	P. Qty.
M5	140 mm	3.5 mm	22 mm	WS8	0051 5 140	100
M5	150 mm	3.5 mm	16 mm	WS8	0051 5 150	100
M6	30 mm	4 mm	18 mm	WS10	0051 6 30	200/500
M6	35 mm	4 mm	18 mm	WS10	0051 6 35	200/500
M6	40 mm	4 mm	18 mm	WS10	0051 6 40	200
M6	45 mm	4 mm	18 mm	WS10	0051 6 45	200
M6	50 mm	4 mm	18 mm	WS10	0051 6 50	200/400
M6	55 mm	4 mm	18 mm	WS10	0051 6 55	200
M6	60 mm	4 mm	18 mm	WS10	0051 6 60	200
M6	65 mm	4 mm	18 mm	WS10	0051 6 65	200
M6	70 mm	4 mm	18 mm	WS10	0051 6 70	100/200
M6	75 mm	4 mm	18 mm	WS10	0051 6 75	200
M6	80 mm	4 mm	18 mm	WS10	0051 6 80	100/200
M6	85 mm	4 mm	18 mm	WS10	0051 6 85	100
M6	90 mm	4 mm	18 mm	WS10	0051 6 90	100
M6	95 mm	4 mm	18 mm	WS10	0051 6 95	100
M6	100 mm	4 mm	18 mm	WS10	0051 6 100	200
M6	110 mm	4 mm	18 mm	WS10	0051 6 110	100
M6	120 mm	4 mm	18 mm	WS10	0051 6 120	100
M6	130 mm	4 mm	24 mm	WS10	0051 6 130	100
M6	140 mm	4 mm	24 mm	WS10	0051 6 140	100
M6	145 mm	4 mm	24 mm	WS10	0051 6 145	100
M6	150 mm	4 mm	24 mm	WS10	0051 6 150	100
M6	160 mm	4 mm	24 mm	WS10	0051 6 160	100
M6	170 mm	4 mm	24 mm	WS10	0051 6 170	100
M6	180 mm	4 mm	24 mm	WS10	0051 6 180	100
M6	200 mm	4 mm	24 mm	WS10	0051 6 200	100
M8	40 mm	5.3 mm	22 mm	WS13	0051 8 40	200
M8	45 mm	5.3 mm	22 mm	WS13	0051 8 45	200
M8	50 mm	5.3 mm	22 mm	WS13	0051 8 50	100/200
M8	55 mm	5.3 mm	22 mm	WS13	0051 8 55	100/200
M8	60 mm	5.3 mm	22 mm	WS13	0051 8 60	100/200
M8	65 mm	5.3 mm	22 mm	WS13	0051 8 65	100/200
M8	70 mm	5.3 mm	22 mm	WS13	0051 8 70	100/200
M8	75 mm	5.3 mm	22 mm	WS13	0051 8 75	100/200
M8	80 mm	5.3 mm	22 mm	WS13	0051 8 80	100
M8	85 mm	5.3 mm	22 mm	WS13	0051 8 85	50
M8	90 mm	5.3 mm	22 mm	WS13	0051 8 90	50/100
M8	95 mm	5.3 mm	22 mm	WS13	0051 8 95	100
M8	100 mm	5.3 mm	22 mm	WS13	0051 8 100	50/100
M8	110 mm	5.3 mm	22 mm	WS13	0051 8 110	50/75
M8	115 mm	5.3 mm	22 mm	WS13	0051 8 115	200
M8	120 mm	5.3 mm	22 mm	WS13	0051 8 120	50/100
M8	125 mm	5.3 mm	22 mm	WS13	0051 8 125	100
M8	130 mm	5.3 mm	28 mm	WS13	0051 8 130	100
M8	140 mm	5.3 mm	28 mm	WS13	0051 8 140	50
M8	145 mm	5.3 mm	28 mm	WS13	0051 8 145	50
M8	150 mm	5.3 mm	28 mm	WS13	0051 8 150	50
M8	160 mm	5.3 mm	28 mm	WS13	0051 8 160	50
M8	170 mm	5.3 mm	28 mm	WS13	0051 8 170	50
M8	180 mm	5.3 mm	28 mm	WS13	0051 8 180	50
M8	185 mm	5.3 mm	28 mm	WS13	0051 8 185	1
M8	190 mm	5.3 mm	28 mm	WS13	0051 8 190	50

Thread type x nominal diameter (d ₁)	Length (l ₁)	Head height (k ₁)	Thread length (metric thread) (b)	External drive (s ₁)	Art. no.	P. Qty.
M8	200 mm	5.3 mm	28 mm	WS13	0051 8 200	50
M8	220 mm	5.3 mm	41 mm	WS13	0051 8 220	50
M8	230 mm	5.3 mm	41 mm	WS13	0051 8 230	25
M8	250 mm	5.3 mm	41 mm	WS13	0051 8 250	25
M8	260 mm	5.3 mm	41 mm	WS13	0051 8 260	100
M8	280 mm	5.3 mm	41 mm	WS13	0051 8 280	100
M8	300 mm	5.3 mm	41 mm	WS13	0051 8 300	100
M10	45 mm	6.4 mm	26 mm	WS16	0051 910 45	100
M10	50 mm	6.4 mm	26 mm	WS16	0051 910 50	100
M10	55 mm	6.4 mm	26 mm	WS16	0051 910 55	100
M10	60 mm	6.4 mm	26 mm	WS16	0051 910 60	100
M10	65 mm	6.4 mm	26 mm	WS16	0051 910 65	100
M10	70 mm	6.4 mm	26 mm	WS16	0051 910 70	100
M10	75 mm	6.4 mm	26 mm	WS16	0051 910 75	50
M10	80 mm	6.4 mm	26 mm	WS16	0051 910 80	50
M10	85 mm	6.4 mm	26 mm	WS16	0051 910 85	50
M10	90 mm	6.4 mm	26 mm	WS16	0051 910 90	50
M10	95 mm	6.4 mm	26 mm	WS16	0051 910 95	100
M10	100 mm	6.4 mm	26 mm	WS16	0051 910 100	50
M10	110 mm	6.4 mm	26 mm	WS16	0051 910 110	50
M10	120 mm	6.4 mm	26 mm	WS16	0051 910 120	50
M10	130 mm	6.4 mm	32 mm	WS16	0051 910 130	50
M10	135 mm	6.4 mm	32 mm	WS16	0051 910 135	50
M10	140 mm	6.4 mm	32 mm	WS16	0051 910 140	50
M10	150 mm	6.4 mm	32 mm	WS16	0051 910 150	50
M10	155 mm	6.4 mm	32 mm	WS16	0051 910 155	10
M10	160 mm	6.4 mm	32 mm	WS16	0051 910 160	25
M10	170 mm	6.4 mm	32 mm	WS16	0051 910 170	50
M10	180 mm	6.4 mm	32 mm	WS16	0051 910 180	100
M10	210 mm	6.4 mm	45 mm	WS16	0051 910 210	25
M10	230 mm	6.4 mm	45 mm	WS16	0051 910 230	1
M10	270 mm	6.4 mm	45 mm	WS16	0051 910 270	25
M10	280 mm	6.4 mm	45 mm	WS16	0051 910 280	25
M12	50 mm	7.5 mm	30 mm	WS18	0051 912 50	100
M12	55 mm	7.5 mm	30 mm	WS18	0051 912 55	100
M12	60 mm	7.5 mm	30 mm	WS18	0051 912 60	50
M12	65 mm	7.5 mm	30 mm	WS18	0051 912 65	50
M12	70 mm	7.5 mm	30 mm	WS18	0051 912 70	50
M12	75 mm	7.5 mm	30 mm	WS18	0051 912 75	50
M12	80 mm	7.5 mm	30 mm	WS18	0051 912 80	50
M12	85 mm	7.5 mm	30 mm	WS18	0051 912 85	50
M12	90 mm	7.5 mm	30 mm	WS18	0051 912 90	50
M12	95 mm	7.5 mm	30 mm	WS18	0051 912 95	50
M12	100 mm	7.5 mm	30 mm	WS18	0051 912 100	50
M12	110 mm	7.5 mm	30 mm	WS18	0051 912 110	50
M12	120 mm	7.5 mm	30 mm	WS18	0051 912 120	50
M12	125 mm	7.5 mm	30 mm	WS18	0051 912 125	50
M12	130 mm	7.5 mm	36 mm	WS18	0051 912 130	50
M12	140 mm	7.5 mm	36 mm	WS18	0051 912 140	50
M12	150 mm	7.5 mm	36 mm	WS18	0051 912 150	50
M12	155 mm	7.5 mm	36 mm	WS18	0051 912 155	25
M12	160 mm	7.5 mm	36 mm	WS18	0051 912 160	25
M12	165 mm	7.5 mm	36 mm	WS18	0051 912 165	1

Thread type x nominal diameter (d ₁)	Length (l ₁)	Head height (k ₁)	Thread length (metric thread) (b)	External drive (s ₁)	Art. no.	P. Qty.
M12	170 mm	7.5 mm	36 mm	WS18	0051 912 170	25
M12	190 mm	7.5 mm	36 mm	WS18	0051 912 190	25
M12	200 mm	7.5 mm	36 mm	WS18	0051 912 200	25
M12	220 mm	7.5 mm	49 mm	WS18	0051 912 220	25
M12	230 mm	7.5 mm	49 mm	WS18	0051 912 230	25
M12	245 mm	7.5 mm	49 mm	WS18	0051 912 245	10
M12	280 mm	7.5 mm	49 mm	WS18	0051 912 280	25
M14	55 mm	8.8 mm	34 mm	WS21	0051 914 55	50
M14	60 mm	8.8 mm	34 mm	WS21	0051 914 60	50
M14	70 mm	8.8 mm	34 mm	WS21	0051 914 70	50
M14	80 mm	8.8 mm	34 mm	WS21	0051 914 80	50
M14	90 mm	8.8 mm	34 mm	WS21	0051 914 90	50
M14	100 mm	8.8 mm	34 mm	WS21	0051 914 100	50
M14	110 mm	8.8 mm	34 mm	WS21	0051 914 110	50
M14	120 mm	8.8 mm	34 mm	WS21	0051 914 120	50
M14	130 mm	8.8 mm	40 mm	WS21	0051 914 130	50
M14	140 mm	8.8 mm	40 mm	WS21	0051 914 140	25
M14	150 mm	8.8 mm	40 mm	WS21	0051 914 150	25
M14	160 mm	8.8 mm	40 mm	WS21	0051 914 160	25
M14	180 mm	8.8 mm	40 mm	WS21	0051 914 180	25
M16	40 mm	10 mm	26 mm	WS24	0051 16 40	50
M16	45 mm	10 mm	26 mm	WS24	0051 16 45	50
M16	55 mm	10 mm	38 mm	WS24	0051 16 55	50
M16	65 mm	10 mm	38 mm	WS24	0051 16 65	25
M16	70 mm	10 mm	38 mm	WS24	0051 16 70	25
M16	75 mm	10 mm	38 mm	WS24	0051 16 75	25
M16	80 mm	10 mm	38 mm	WS24	0051 16 80	25
M16	85 mm	10 mm	38 mm	WS24	0051 16 85	25
M16	90 mm	10 mm	38 mm	WS24	0051 16 90	25
M16	95 mm	10 mm	38 mm	WS24	0051 16 95	25
M16	100 mm	10 mm	38 mm	WS24	0051 16 100	25
M16	110 mm	10 mm	38 mm	WS24	0051 16 110	25
M16	120 mm	10 mm	38 mm	WS24	0051 16 120	25
M16	130 mm	10 mm	44 mm	WS24	0051 16 130	25
M16	135 mm	10 mm	44 mm	WS24	0051 16 135	25
M16	140 mm	10 mm	44 mm	WS24	0051 16 140	25
M16	150 mm	10 mm	44 mm	WS24	0051 16 150	25
M16	160 mm	10 mm	44 mm	WS24	0051 16 160	25
M16	165 mm	10 mm	44 mm	WS24	0051 16 165	25
M16	170 mm	10 mm	44 mm	WS24	0051 16 170	25
M16	180 mm	10 mm	44 mm	WS24	0051 16 180	25
M16	185 mm	10 mm	44 mm	WS24	0051 16 185	25
M16	190 mm	10 mm	44 mm	WS24	0051 16 190	25
M16	200 mm	10 mm	57 mm	WS24	0051 16 200	25
M16	210 mm	10 mm	57 mm	WS24	0051 16 210	25
M16	220 mm	10 mm	57 mm	WS24	0051 16 220	25
M16	230 mm	10 mm	57 mm	WS24	0051 16 230	25
M16	240 mm	10 mm	57 mm	WS24	0051 16 240	25
M16	250 mm	10 mm	57 mm	WS24	0051 16 250	25
M16	260 mm	10 mm	57 mm	WS24	0051 16 260	25
M16	270 mm	10 mm	57 mm	WS24	0051 16 270	25
M16	280 mm	10 mm	57 mm	WS24	0051 16 280	25
M16	290 mm	10 mm	57 mm	WS24	0051 16 290	10

Thread type x nominal diameter (d ₁)	Length (l ₁)	Head height (k ₁)	Thread length (metric thread) (b)	External drive (s ₁)	Art. no.	P. Qty.
M16	300 mm	10 mm	57 mm	WS24	0051 16 300	25
M16	310 mm	10 mm	57 mm	WS24	0051 16 310	1
M16	320 mm	10 mm	57 mm	WS24	0051 16 320	10
M16	330 mm	10 mm	57 mm	WS24	0051 16 330	10
M16	340 mm	10 mm	57 mm	WS24	0051 16 340	10
M16	350 mm	10 mm	57 mm	WS24	0051 16 350	10
M16	360 mm	10 mm	57 mm	WS24	0051 16 360	1
M16	370 mm	10 mm	57 mm	WS24	0051 16 370	10
M16	390 mm	10 mm	57 mm	WS24	0051 16 390	10
M16	420 mm	10 mm	57 mm	WS24	0051 16 420	25
M16	440 mm	10 mm	57 mm	WS24	0051 16 440	10
M18	70 mm	11.5 mm	42 mm	WS27	0051 18 70	25
M18	75 mm	11.5 mm	42 mm	WS27	0051 18 75	25
M18	80 mm	11.5 mm	42 mm	WS27	0051 18 80	25
M18	85 mm	11.5 mm	42 mm	WS27	0051 18 85	25
M18	90 mm	11.5 mm	42 mm	WS27	0051 18 90	25
M18	100 mm	11.5 mm	42 mm	WS27	0051 18 100	25
M18	110 mm	11.5 mm	42 mm	WS27	0051 18 110	25
M18	120 mm	11.5 mm	42 mm	WS27	0051 18 120	25
M18	130 mm	11.5 mm	48 mm	WS27	0051 18 130	25
M18	140 mm	11.5 mm	48 mm	WS27	0051 18 140	25
M18	150 mm	11.5 mm	48 mm	WS27	0051 18 150	25
M18	160 mm	11.5 mm	48 mm	WS27	0051 18 160	25
M18	170 mm	11.5 mm	48 mm	WS27	0051 18 170	10
M18	180 mm	11.5 mm	48 mm	WS27	0051 18 180	10
M18	190 mm	11.5 mm	48 mm	WS27	0051 18 190	10
M18	200 mm	11.5 mm	48 mm	WS27	0051 18 200	25
M18	210 mm	11.5 mm	61 mm	WS27	0051 18 210	10
M18	220 mm	11.5 mm	61 mm	WS27	0051 18 220	25
M18	230 mm	11.5 mm	61 mm	WS27	0051 18 230	10
M18	240 mm	11.5 mm	61 mm	WS27	0051 18 240	25
M18	250 mm	11.5 mm	61 mm	WS27	0051 18 250	10
M18	260 mm	11.5 mm	61 mm	WS27	0051 18 260	25
M18	280 mm	11.5 mm	61 mm	WS27	0051 18 280	25
M18	290 mm	11.5 mm	61 mm	WS27	0051 18 290	10
M18	300 mm	11.5 mm	61 mm	WS27	0051 18 300	30
M20	75 mm	12.5 mm	46 mm	WS30	0051 20 75	25
M20	80 mm	12.5 mm	46 mm	WS30	0051 20 80	25
M20	85 mm	12.5 mm	46 mm	WS30	0051 20 85	25
M20	90 mm	12.5 mm	46 mm	WS30	0051 20 90	25
M20	95 mm	12.5 mm	46 mm	WS30	0051 20 95	25
M20	100 mm	12.5 mm	46 mm	WS30	0051 20 100	25
M20	105 mm	12.5 mm	46 mm	WS30	0051 20 105	25
M20	110 mm	12.5 mm	46 mm	WS30	0051 20 110	25
M20	120 mm	12.5 mm	46 mm	WS30	0051 20 120	25
M20	130 mm	12.5 mm	52 mm	WS30	0051 20 130	25
M20	135 mm	12.5 mm	52 mm	WS30	0051 20 135	25
M20	140 mm	12.5 mm	52 mm	WS30	0051 20 140	25
M20	150 mm	12.5 mm	52 mm	WS30	0051 20 150	10/25
M20	160 mm	12.5 mm	52 mm	WS30	0051 20 160	10
M20	170 mm	12.5 mm	52 mm	WS30	0051 20 170	10
M20	180 mm	12.5 mm	52 mm	WS30	0051 20 180	10
M20	185 mm	12.5 mm	52 mm	WS30	0051 20 185	10

Thread type x nominal diameter (d ₁)	Length (l ₁)	Head height (k ₁)	Thread length (metric thread) (b)	External drive (s ₁)	Art. no.	P. Qty.
M20	190 mm	12.5 mm	52 mm	WS30	0051 20 190	10
M20	195 mm	12.5 mm	52 mm	WS30	0051 20 195	5
M20	200 mm	12.5 mm	52 mm	WS30	0051 20 200	10
M20	210 mm	12.5 mm	65 mm	WS30	0051 20 210	10
M20	220 mm	12.5 mm	65 mm	WS30	0051 20 220	1/10
M20	225 mm	12.5 mm	65 mm	WS30	0051 20 225	10
M20	230 mm	12.5 mm	65 mm	WS30	0051 20 230	10
M20	240 mm	12.5 mm	65 mm	WS30	0051 20 240	1/10
M20	250 mm	12.5 mm	65 mm	WS30	0051 20 250	10
M20	260 mm	12.5 mm	65 mm	WS30	0051 20 260	1/10
M20	265 mm	12.5 mm	65 mm	WS30	0051 20 265	50
M20	270 mm	12.5 mm	65 mm	WS30	0051 20 270	10
M20	280 mm	12.5 mm	65 mm	WS30	0051 20 280	10
M20	290 mm	12.5 mm	65 mm	WS30	0051 20 290	1
M20	300 mm	12.5 mm	65 mm	WS30	0051 20 300	10
M20	320 mm	12.5 mm	65 mm	WS30	0051 20 320	10
M20	340 mm	12.5 mm	65 mm	WS30	0051 20 340	10
M20	350 mm	12.5 mm	65 mm	WS30	0051 20 350	10
M20	360 mm	12.5 mm	65 mm	WS30	0051 20 360	10
M20	370 mm	12.5 mm	65 mm	WS30	0051 20 370	25
M20	380 mm	12.5 mm	65 mm	WS30	0051 20 380	10
M20	390 mm	12.5 mm	65 mm	WS30	0051 20 390	10
M20	400 mm	12.5 mm	65 mm	WS30	0051 20 400	10
M20	420 mm	12.5 mm	65 mm	WS30	0051 20 420	10
M20	440 mm	12.5 mm	65 mm	WS30	0051 20 440	10
M20	460 mm	12.5 mm	65 mm	WS30	0051 20 460	10
M20	480 mm	12.5 mm	65 mm	WS30	0051 20 480	10
M20	500 mm	12.5 mm	65 mm	WS30	0051 20 500	10
M20	520 mm	12.5 mm	65 mm	WS30	0051 20 520	5
M24	85 mm	15 mm	54 mm	WS36	0051 24 85	10
M24	90 mm	15 mm	54 mm	WS36	0051 24 90	10
M24	95 mm	15 mm	54 mm	WS36	0051 24 95	10
M24	100 mm	15 mm	54 mm	WS36	0051 24 100	10
M24	105 mm	15 mm	54 mm	WS36	0051 24 105	1
M24	110 mm	15 mm	54 mm	WS36	0051 24 110	10
M24	115 mm	15 mm	54 mm	WS36	0051 24 115	10
M24	120 mm	15 mm	54 mm	WS36	0051 24 120	10
M24	125 mm	15 mm	54 mm	WS36	0051 24 125	10
M24	130 mm	15 mm	60 mm	WS36	0051 24 130	1/10
M24	140 mm	15 mm	60 mm	WS36	0051 24 140	1/10
M24	150 mm	15 mm	60 mm	WS36	0051 24 150	1/10
M24	160 mm	15 mm	60 mm	WS36	0051 24 160	10
M24	170 mm	15 mm	60 mm	WS36	0051 24 170	10
M24	180 mm	15 mm	60 mm	WS36	0051 24 180	10
M24	190 mm	15 mm	60 mm	WS36	0051 24 190	10
M24	200 mm	15 mm	60 mm	WS36	0051 24 200	10
M24	210 mm	15 mm	73 mm	WS36	0051 24 210	5
M24	220 mm	15 mm	73 mm	WS36	0051 24 220	1/10
M24	230 mm	15 mm	73 mm	WS36	0051 24 230	10
M24	240 mm	15 mm	73 mm	WS36	0051 24 240	1/5/10
M24	250 mm	15 mm	73 mm	WS36	0051 24 250	5
M24	260 mm	15 mm	73 mm	WS36	0051 24 260	1/10
M24	280 mm	15 mm	73 mm	WS36	0051 24 280	1/10

Thread type x nominal diameter (d ₁)	Length (l ₁)	Head height (k ₁)	Thread length (metric thread) (b)	External drive (s ₁)	Art. no.	P. Qty.
M24	300 mm	15 mm	73 mm	WS36	0051 24 300	1/10
M24	310 mm	15 mm	73 mm	WS36	0051 24 310	5
M24	320 mm	15 mm	73 mm	WS36	0051 24 320	10
M24	340 mm	15 mm	73 mm	WS36	0051 24 340	10
M24	350 mm	15 mm	73 mm	WS36	0051 24 350	10
M24	360 mm	15 mm	73 mm	WS36	0051 24 360	10
M24	380 mm	15 mm	73 mm	WS36	0051 24 380	1/10
M24	400 mm	15 mm	73 mm	WS36	0051 24 400	10
M24	440 mm	15 mm	73 mm	WS36	0051 24 440	1
M24	460 mm	15 mm	73 mm	WS36	0051 24 460	1
M24	520 mm	15 mm	73 mm	WS36	0051 24 520	1
M24	600 mm	15 mm	73 mm	WS36	0051 24 600	5
M27	100 mm	17 mm	60 mm	WS41	0051 27 100	10
M27	110 mm	17 mm	60 mm	WS41	0051 27 110	10
M27	120 mm	17 mm	60 mm	WS41	0051 27 120	10
M27	130 mm	17 mm	66 mm	WS41	0051 27 130	10
M27	140 mm	17 mm	66 mm	WS41	0051 27 140	10
M27	150 mm	17 mm	66 mm	WS41	0051 27 150	10
M27	160 mm	17 mm	66 mm	WS41	0051 27 160	10
M27	170 mm	17 mm	66 mm	WS41	0051 27 170	10
M27	180 mm	17 mm	66 mm	WS41	0051 27 180	10
M27	185 mm	17 mm	66 mm	WS41	0051 27 185	10
M27	190 mm	17 mm	66 mm	WS41	0051 27 190	10
M27	200 mm	17 mm	66 mm	WS41	0051 27 200	10
M27	210 mm	17 mm	79 mm	WS41	0051 27 210	1
M27	220 mm	17 mm	79 mm	WS41	0051 27 220	10
M27	230 mm	17 mm	79 mm	WS41	0051 27 230	10
M27	240 mm	17 mm	79 mm	WS41	0051 27 240	1
M27	260 mm	17 mm	79 mm	WS41	0051 27 260	10
M27	270 mm	17 mm	79 mm	WS41	0051 27 270	10
M27	320 mm	17 mm	79 mm	WS41	0051 27 320	5
M27	350 mm	17 mm	79 mm	WS41	0051 27 350	10
M27	360 mm	17 mm	79 mm	WS41	0051 27 360	10
M27	380 mm	17 mm	79 mm	WS41	0051 27 380	1
M27	390 mm	17 mm	79 mm	WS41	0051 27 390	5
M27	400 mm	17 mm	79 mm	WS41	0051 27 400	5
M27	460 mm	17 mm	79 mm	WS41	0051 27 460	1
M30	110 mm	18.7 mm	66 mm	WS46	0051 30 110	1/10
M30	120 mm	18.7 mm	66 mm	WS46	0051 30 120	1/5/10
M30	130 mm	18.7 mm	72 mm	WS46	0051 30 130	1/10
M30	135 mm	18.7 mm	72 mm	WS46	0051 30 135	10
M30	140 mm	18.7 mm	72 mm	WS46	0051 30 140	1/10
M30	150 mm	18.7 mm	72 mm	WS46	0051 30 150	1/5/10
M30	160 mm	18.7 mm	72 mm	WS46	0051 30 160	1/10/20
M30	165 mm	18.7 mm	72 mm	WS46	0051 30 165	5
M30	170 mm	18.7 mm	72 mm	WS46	0051 30 170	10
M30	180 mm	18.7 mm	72 mm	WS46	0051 30 180	1/5/10
M30	190 mm	18.7 mm	72 mm	WS46	0051 30 190	10
M30	200 mm	18.7 mm	72 mm	WS46	0051 30 200	1/5
M30	210 mm	18.7 mm	85 mm	WS46	0051 30 210	5
M30	220 mm	18.7 mm	85 mm	WS46	0051 30 220	1/5
M30	230 mm	18.7 mm	85 mm	WS46	0051 30 230	5
M30	240 mm	18.7 mm	85 mm	WS46	0051 30 240	1/5

Thread type x nominal diameter (d ₁)	Length (l ₁)	Head height (k ₁)	Thread length (metric thread) (b)	External drive (s ₁)	Art. no.	P. Qty.
M30	250 mm	18.7 mm	85 mm	WS46	0051 30 250	5
M30	260 mm	18.7 mm	85 mm	WS46	0051 30 260	1/5
M30	270 mm	18.7 mm	85 mm	WS46	0051 30 270	5
M30	280 mm	18.7 mm	85 mm	WS46	0051 30 280	10
M30	290 mm	18.7 mm	85 mm	WS46	0051 30 290	5
M30	300 mm	18.7 mm	85 mm	WS46	0051 30 300	10
M30	310 mm	18.7 mm	85 mm	WS46	0051 30 310	5
M30	320 mm	18.7 mm	85 mm	WS46	0051 30 320	5
M30	330 mm	18.7 mm	85 mm	WS46	0051 30 330	10
M30	360 mm	18.7 mm	85 mm	WS46	0051 30 360	5
M30	370 mm	18.7 mm	85 mm	WS46	0051 30 370	5
M30	390 mm	18.7 mm	85 mm	WS46	0051 30 390	5
M30	420 mm	18.7 mm	85 mm	WS46	0051 30 420	1
M30	440 mm	18.7 mm	85 mm	WS46	0051 30 440	10
M30	450 mm	18.7 mm	85 mm	WS46	0051 30 450	1
M30	460 mm	18.7 mm	85 mm	WS46	0051 30 460	5
M30	480 mm	18.7 mm	85 mm	WS46	0051 30 480	5
M30	540 mm	18.7 mm	85 mm	WS46	0051 30 540	1
M30	560 mm	18.7 mm	85 mm	WS46	0051 30 560	1
M30	600 mm	18.7 mm	85 mm	WS46	0051 30 600	5
M30	680 mm	18.7 mm	85 mm	WS46	0051 30 680	5
M33	130 mm	21 mm	78 mm	WS50	0051 33 130	5
M33	140 mm	21 mm	78 mm	WS50	0051 33 140	10
M33	150 mm	21 mm	78 mm	WS50	0051 33 150	5
M33	160 mm	21 mm	78 mm	WS50	0051 33 160	10
M33	170 mm	21 mm	78 mm	WS50	0051 33 170	10
M33	180 mm	21 mm	78 mm	WS50	0051 33 180	5
M33	190 mm	21 mm	78 mm	WS50	0051 33 190	5
M33	200 mm	21 mm	78 mm	WS50	0051 33 200	10
M33	210 mm	21 mm	91 mm	WS50	0051 33 210	10
M33	220 mm	21 mm	91 mm	WS50	0051 33 220	10
M33	230 mm	21 mm	91 mm	WS50	0051 33 230	5
M33	250 mm	21 mm	91 mm	WS50	0051 33 250	5
M33	260 mm	21 mm	91 mm	WS50	0051 33 260	1
M33	270 mm	21 mm	91 mm	WS50	0051 33 270	10
M33	300 mm	21 mm	91 mm	WS50	0051 33 300	5
M33	310 mm	21 mm	91 mm	WS50	0051 33 310	1
M33	320 mm	21 mm	91 mm	WS50	0051 33 320	5
M36	140 mm	22.5 mm	84 mm	WS55	0051 36 140	5
M36	150 mm	22.5 mm	84 mm	WS55	0051 36 150	5
M36	160 mm	22.5 mm	84 mm	WS55	0051 36 160	10
M36	170 mm	22.5 mm	84 mm	WS55	0051 36 170	5
M36	180 mm	22.5 mm	84 mm	WS55	0051 36 180	5
M36	190 mm	22.5 mm	84 mm	WS55	0051 36 190	5
M36	200 mm	22.5 mm	84 mm	WS55	0051 36 200	5
M36	210 mm	22.5 mm	97 mm	WS55	0051 36 210	10
M36	220 mm	22.5 mm	97 mm	WS55	0051 36 220	5
M36	230 mm	22.5 mm	97 mm	WS55	0051 36 230	5
M36	240 mm	22.5 mm	97 mm	WS55	0051 36 240	5
M36	250 mm	22.5 mm	97 mm	WS55	0051 36 250	5
M36	260 mm	22.5 mm	97 mm	WS55	0051 36 260	5
M36	280 mm	22.5 mm	97 mm	WS55	0051 36 280	1
M36	290 mm	22.5 mm	97 mm	WS55	0051 36 290	1

Thread type x nominal diameter (d ₁)	Length (l ₁)	Head height (k ₁)	Thread length (metric thread) (b)	External drive (s ₁)	Art. no.	P. Qty.
M36	300 mm	22.5 mm	97 mm	WS55	0051 36 300	5
M36	320 mm	22.5 mm	97 mm	WS55	0051 36 320	1
M36	330 mm	22.5 mm	97 mm	WS55	0051 36 330	5
M36	340 mm	22.5 mm	97 mm	WS55	0051 36 340	5
M36	350 mm	22.5 mm	97 mm	WS55	0051 36 350	1
M36	360 mm	22.5 mm	97 mm	WS55	0051 36 360	1
M36	380 mm	22.5 mm	97 mm	WS55	0051 36 380	1
M36	400 mm	22.5 mm	97 mm	WS55	0051 36 400	5
M36	450 mm	22.5 mm	97 mm	WS55	0051 36 450	1
M36	480 mm	22.5 mm	97 mm	WS55	0051 36 480	5
M36	500 mm	22.5 mm	97 mm	WS55	0051 36 500	1
M36	540 mm	22.5 mm	97 mm	WS55	0051 36 540	5
M39	160 mm	25 mm	90 mm	WS60	0051 39 160	10
M39	170 mm	25 mm	90 mm	WS60	0051 39 170	1
M39	180 mm	25 mm	90 mm	WS60	0051 39 180	5
M39	190 mm	25 mm	90 mm	WS60	0051 39 190	10
M39	220 mm	25 mm	103 mm	WS60	0051 39 220	1
M39	240 mm	25 mm	103 mm	WS60	0051 39 240	10
M39	250 mm	25 mm	103 mm	WS60	0051 39 250	5
M39	260 mm	25 mm	103 mm	WS60	0051 39 260	8
M39	280 mm	25 mm	103 mm	WS60	0051 39 280	5
M39	330 mm	25 mm	103 mm	WS60	0051 39 330	5
M42	160 mm	26 mm	96 mm	WS65	0051 42 160	5
M42	170 mm	26 mm	96 mm	WS65	0051 42 170	5
M42	180 mm	26 mm	96 mm	WS65	0051 42 180	5
M42	190 mm	26 mm	96 mm	WS65	0051 42 190	5
M42	200 mm	26 mm	96 mm	WS65	0051 42 200	5
M42	210 mm	26 mm	109 mm	WS65	0051 42 210	1
M42	220 mm	26 mm	109 mm	WS65	0051 42 220	5
M42	230 mm	26 mm	109 mm	WS65	0051 42 230	1
M42	240 mm	26 mm	109 mm	WS65	0051 42 240	5
M42	260 mm	26 mm	109 mm	WS65	0051 42 260	5
M42	290 mm	26 mm	109 mm	WS65	0051 42 290	1
M42	300 mm	26 mm	109 mm	WS65	0051 42 300	1
M42	320 mm	26 mm	109 mm	WS65	0051 42 320	5
M42	340 mm	26 mm	109 mm	WS65	0051 42 340	1
M42	360 mm	26 mm	109 mm	WS65	0051 42 360	5
M42	380 mm	26 mm	109 mm	WS65	0051 42 380	5
M42	440 mm	26 mm	109 mm	WS65	0051 42 440	1
M42	520 mm	26 mm	109 mm	WS65	0051 42 520	1
M45	170 mm	28 mm	102 mm	WS70	0051 45 170	5
M45	200 mm	28 mm	102 mm	WS70	0051 45 200	5
M45	220 mm	28 mm	115 mm	WS70	0051 45 220	5
M45	300 mm	28 mm	115 mm	WS70	0051 45 300	5
M48	170 mm	30 mm	108 mm	WS75	0051 48 170	5
M48	180 mm	30 mm	108 mm	WS75	0051 48 180	5
M48	190 mm	30 mm	108 mm	WS75	0051 48 190	5
M48	200 mm	30 mm	108 mm	WS75	0051 48 200	5
M48	220 mm	30 mm	121 mm	WS75	0051 48 220	5
M48	240 mm	30 mm	121 mm	WS75	0051 48 240	1
M48	250 mm	30 mm	121 mm	WS75	0051 48 250	5
M48	260 mm	30 mm	121 mm	WS75	0051 48 260	5
M48	280 mm	30 mm	121 mm	WS75	0051 48 280	1

Thread type x nominal diameter (d ₁)	Length (l ₁)	Head height (k ₁)	Thread length (metric thread) (b)	External drive (s ₁)	Art. no.	P. Qty.
M48	300 mm	30 mm	121 mm	WS75	0051 48 300	4
M48	310 mm	30 mm	121 mm	WS75	0051 48 310	1
M48	320 mm	30 mm	121 mm	WS75	0051 48 320	1/5
M48	330 mm	30 mm	121 mm	WS75	0051 48 330	1
M48	340 mm	30 mm	121 mm	WS75	0051 48 340	1
M48	360 mm	30 mm	121 mm	WS75	0051 48 360	1
M48	380 mm	30 mm	121 mm	WS75	0051 48 380	1
M48	500 mm	30 mm	121 mm	WS75	0051 48 500	5
M48	580 mm	30 mm	121 mm	WS75	0051 48 580	5
M52	200 mm	33 mm	116 mm	WS80	0051 52 200	1
M52	300 mm	33 mm	129 mm	WS80	0051 52 300	1
M56	220 mm	35 mm	137 mm	WS85	0051 56 220	1
M56	240 mm	35 mm	137 mm	WS85	0051 56 240	1
M56	280 mm	35 mm	137 mm	WS85	0051 56 280	1
M56	350 mm	35 mm	137 mm	WS85	0051 56 350	1
M56	380 mm	35 mm	137 mm	WS85	0051 56 380	5
M56	500 mm	35 mm	137 mm	WS85	0051 56 500	1
M64	250 mm	40 mm	153 mm	WS95	0051 64 250	1
M64	400 mm	40 mm	153 mm	WS95	0051 64 400	1
M64	500 mm	40 mm	153 mm	WS95	0051 64 320	1

Notice

ISO 4014 replaces DIN 931 | There is some similarity | Nominal size extended | Width across flats for M10, M12, M14 and M22 changed.