

Hexagonal bolt with shank

ISO 4014, steel 8.8, galvanised, blue passivated (A2K)

Standards	ISO 4014
Material	Steel
Property class	8.8
Surface	Zinc plated
RoHS-compliant	Yes

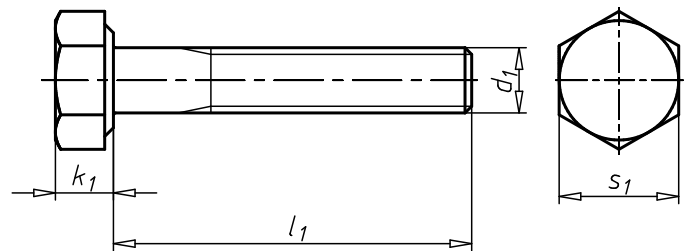

Thread type x nominal diameter (d ₁)	Length (l ₁)	Head height (k ₁)	Thread length (metric thread) (b)	External drive (s ₁)	Art. no.	P. Qty.
M3	30 mm	2 mm	12 mm	WS5.5	0053 3 30	500
M4	25 mm	2.8 mm	14 mm	WS7	0053 4 25	500
M4	30 mm	2.8 mm	14 mm	WS7	0053 4 30	500
M4	35 mm	2.8 mm	14 mm	WS7	0053 4 35	500
M4	40 mm	2.8 mm	14 mm	WS7	0053 4 40	200
M4	45 mm	2.8 mm	14 mm	WS7	0053 4 45	500
M4	50 mm	2.8 mm	14 mm	WS7	0053 4 50	200/500
M4	55 mm	2.8 mm	14 mm	WS7	0053 4 55	500
M4	60 mm	2.8 mm	14 mm	WS7	0053 4 60	200
M4	65 mm	2.8 mm	14 mm	WS7	0053 4 65	200
M4	70 mm	2.8 mm	14 mm	WS7	0053 4 70	200
M4	75 mm	2.8 mm	14 mm	WS7	0053 4 75	200
M4	80 mm	2.8 mm	14 mm	WS7	0053 4 80	200
M4	85 mm	2.8 mm	14 mm	WS7	0053 4 85	200
M4	90 mm	2.8 mm	14 mm	WS7	0053 4 90	200
M5	25 mm	3.5 mm	16 mm	WS8	0053 5 25	200
M5	30 mm	3.5 mm	16 mm	WS8	0053 5 30	200/500
M5	35 mm	3.5 mm	16 mm	WS8	0053 5 35	200/500
M5	40 mm	3.5 mm	16 mm	WS8	0053 5 40	200
M5	45 mm	3.5 mm	16 mm	WS8	0053 5 45	100/500
M5	50 mm	3.5 mm	16 mm	WS8	0053 5 50	200/500
M5	55 mm	3.5 mm	16 mm	WS8	0053 5 55	100/200
M5	60 mm	3.5 mm	16 mm	WS8	0053 5 60	200
M5	65 mm	3.5 mm	16 mm	WS8	0053 5 65	200/400
M5	70 mm	3.5 mm	16 mm	WS8	0053 5 70	200
M5	75 mm	3.5 mm	16 mm	WS8	0053 5 75	200
M5	80 mm	3.5 mm	16 mm	WS8	0053 5 80	100/200
M5	85 mm	3.5 mm	16 mm	WS8	0053 5 85	200
M5	90 mm	3.5 mm	16 mm	WS8	0053 5 90	100
M5	95 mm	3.5 mm	16 mm	WS8	0053 5 95	200
M5	100 mm	3.5 mm	16 mm	WS8	0053 5 100	100
M5	110 mm	3.5 mm	16 mm	WS8	0053 5 110	200

Thread type x nominal diameter (d ₁)	Length (l ₁)	Head height (k ₁)	Thread length (metric thread) (b)	External drive (s ₁)	Art. no.	P. Qty.
M5	130 mm	3.5 mm	22 mm	WS8	0053 5 130	100
M5	140 mm	3.5 mm	22 mm	WS8	0053 5 140	100
M5	180 mm	3.5 mm	22 mm	WS8	0053 5 180	50
M6	30 mm	4 mm	18 mm	WS10	0053 6 30	200/500
M6	32 mm	4 mm	18 mm	WS10	0053 6 32	500
M6	35 mm	4 mm	18 mm	WS10	0053 6 35	200
M6	38 mm	4 mm	18 mm	WS10	0053 6 38	200
M6	40 mm	4 mm	18 mm	WS10	0053 6 40	200/500
M6	42 mm	4 mm	18 mm	WS10	0053 6 42	200
M6	45 mm	4 mm	18 mm	WS10	0053 6 45	200
M6	50 mm	4 mm	18 mm	WS10	0053 6 50	200
M6	55 mm	4 mm	18 mm	WS10	0053 6 55	100/200
M6	60 mm	4 mm	18 mm	WS10	0053 6 60	100/200
M6	65 mm	4 mm	18 mm	WS10	0053 6 65	100/200
M6	70 mm	4 mm	18 mm	WS10	0053 6 70	100/200
M6	75 mm	4 mm	18 mm	WS10	0053 6 75	100/200
M6	80 mm	4 mm	18 mm	WS10	0053 6 80	100/200
M6	85 mm	4 mm	18 mm	WS10	0053 6 85	100
M6	90 mm	4 mm	18 mm	WS10	0053 6 90	100/250
M6	95 mm	4 mm	18 mm	WS10	0053 6 95	250
M6	100 mm	4 mm	18 mm	WS10	0053 6 100	50/200
M6	110 mm	4 mm	18 mm	WS10	0053 6 110	50/100
M6	115 mm	4 mm	18 mm	WS10	0053 6 115	200
M6	120 mm	4 mm	18 mm	WS10	0053 6 120	50/100
M6	125 mm	4 mm	18 mm	WS10	0053 6 125	100
M6	130 mm	4 mm	24 mm	WS10	0053 6 130	100
M6	140 mm	4 mm	24 mm	WS10	0053 6 140	100
M6	150 mm	4 mm	24 mm	WS10	0053 6 150	100
M6	155 mm	4 mm	24 mm	WS10	0053 6 155	100
M6	160 mm	4 mm	24 mm	WS10	0053 6 160	100
M6	180 mm	4 mm	24 mm	WS10	0053 6 180	100
M6	190 mm	4 mm	24 mm	WS10	0053 6 190	50
M6	200 mm	4 mm	24 mm	WS10	0053 6 200	100
M6	290 mm	4 mm	37 mm	WS10	0053 6 290	25
M8	40 mm	5.3 mm	22 mm	WS13	0053 8 40	200
M8	45 mm	5.3 mm	22 mm	WS13	0053 8 45	200
M8	50 mm	5.3 mm	22 mm	WS13	0053 8 50	200
M8	55 mm	5.3 mm	22 mm	WS13	0053 8 55	200
M8	60 mm	5.3 mm	22 mm	WS13	0053 8 60	200
M8	65 mm	5.3 mm	22 mm	WS13	0053 8 65	200
M8	70 mm	5.3 mm	22 mm	WS13	0053 8 70	200
M8	75 mm	5.3 mm	22 mm	WS13	0053 8 75	50/200
M8	80 mm	5.3 mm	22 mm	WS13	0053 8 80	200
M8	85 mm	5.3 mm	22 mm	WS13	0053 8 85	50/100
M8	90 mm	5.3 mm	22 mm	WS13	0053 8 90	50/100
M8	95 mm	5.3 mm	22 mm	WS13	0053 8 95	50/100
M8	100 mm	5.3 mm	22 mm	WS13	0053 8 100	50/100
M8	105 mm	5.3 mm	22 mm	WS13	0053 8 105	100
M8	110 mm	5.3 mm	22 mm	WS13	0053 8 110	50/75
M8	120 mm	5.3 mm	22 mm	WS13	0053 8 120	50/100
M8	125 mm	5.3 mm	22 mm	WS13	0053 8 125	100
M8	130 mm	5.3 mm	28 mm	WS13	0053 8 130	50/100
M8	140 mm	5.3 mm	28 mm	WS13	0053 8 140	50

Thread type x nominal diameter (d ₁)	Length (l ₁)	Head height (k ₁)	Thread length (metric thread) (b)	External drive (s ₁)	Art. no.	P. Qty.
M8	150 mm	5.3 mm	28 mm	WS13	0053 8 150	50/100
M8	160 mm	5.3 mm	28 mm	WS13	0053 8 160	50
M8	170 mm	5.3 mm	28 mm	WS13	0053 8 170	100
M8	180 mm	5.3 mm	28 mm	WS13	0053 8 180	50/200
M8	185 mm	5.3 mm	28 mm	WS13	0053 8 185	50
M8	190 mm	5.3 mm	28 mm	WS13	0053 8 190	50
M8	200 mm	5.3 mm	28 mm	WS13	0053 8 200	50/100
M8	210 mm	5.3 mm	41 mm	WS13	0053 8 210	50
M8	220 mm	5.3 mm	41 mm	WS13	0053 8 220	50
M8	240 mm	5.3 mm	41 mm	WS13	0053 8 240	50
M8	260 mm	5.3 mm	41 mm	WS13	0053 8 260	50
M8	280 mm	5.3 mm	41 mm	WS13	0053 8 280	50
M8	300 mm	5.3 mm	41 mm	WS13	0053 8 300	50
M10	45 mm	6.4 mm	26 mm	WS16	0053 910 45	100
M10	50 mm	6.4 mm	26 mm	WS16	0053 910 50	100
M10	55 mm	6.4 mm	26 mm	WS16	0053 910 55	100
M10	60 mm	6.4 mm	26 mm	WS16	0053 910 60	100
M10	65 mm	6.4 mm	26 mm	WS16	0053 910 65	100
M10	70 mm	6.4 mm	26 mm	WS16	0053 910 70	50/100
M10	75 mm	6.4 mm	26 mm	WS16	0053 910 75	50
M10	80 mm	6.4 mm	26 mm	WS16	0053 910 80	50/100
M10	85 mm	6.4 mm	26 mm	WS16	0053 910 85	50
M10	90 mm	6.4 mm	26 mm	WS16	0053 910 90	100
M10	100 mm	6.4 mm	26 mm	WS16	0053 910 100	100
M10	110 mm	6.4 mm	26 mm	WS16	0053 910 110	50
M10	120 mm	6.4 mm	26 mm	WS16	0053 910 120	50
M10	130 mm	6.4 mm	32 mm	WS16	0053 910 130	50
M10	140 mm	6.4 mm	32 mm	WS16	0053 910 140	50
M10	150 mm	6.4 mm	32 mm	WS16	0053 910 150	50
M10	160 mm	6.4 mm	32 mm	WS16	0053 910 160	50
M10	180 mm	6.4 mm	32 mm	WS16	0053 910 180	50
M10	190 mm	6.4 mm	32 mm	WS16	0053 910 190	50
M10	200 mm	6.4 mm	32 mm	WS16	0053 910 200	50
M12	50 mm	7.5 mm	30 mm	WS18	0053 912 50	50/100
M12	55 mm	7.5 mm	30 mm	WS18	0053 912 55	100
M12	60 mm	7.5 mm	30 mm	WS18	0053 912 60	100
M12	65 mm	7.5 mm	30 mm	WS18	0053 912 65	50
M12	70 mm	7.5 mm	30 mm	WS18	0053 912 70	50
M12	75 mm	7.5 mm	30 mm	WS18	0053 912 75	50
M12	80 mm	7.5 mm	30 mm	WS18	0053 912 80	50
M12	85 mm	7.5 mm	30 mm	WS18	0053 912 85	50
M12	90 mm	7.5 mm	30 mm	WS18	0053 912 90	50
M12	95 mm	7.5 mm	30 mm	WS18	0053 912 95	50
M12	100 mm	7.5 mm	30 mm	WS18	0053 912 100	25/50
M12	110 mm	7.5 mm	30 mm	WS18	0053 912 110	25/50
M12	120 mm	7.5 mm	30 mm	WS18	0053 912 120	25/50
M12	125 mm	7.5 mm	30 mm	WS18	0053 912 125	25
M12	130 mm	7.5 mm	36 mm	WS18	0053 912 130	25/50
M12	140 mm	7.5 mm	36 mm	WS18	0053 912 140	25/50
M12	145 mm	7.5 mm	36 mm	WS18	0053 912 145	25
M12	150 mm	7.5 mm	36 mm	WS18	0053 912 150	50
M12	155 mm	7.5 mm	36 mm	WS18	0053 912 155	25
M12	160 mm	7.5 mm	36 mm	WS18	0053 912 160	25

Thread type x nominal diameter (d ₁)	Length (l ₁)	Head height (k ₁)	Thread length (metric thread) (b)	External drive (s ₁)	Art. no.	P. Qty.
M12	180 mm	7.5 mm	36 mm	WS18	0053 912 180	25
M12	200 mm	7.5 mm	36 mm	WS18	0053 912 200	25
M12	215 mm	7.5 mm	49 mm	WS18	0053 912 215	25
M12	280 mm	7.5 mm	49 mm	WS18	0053 912 280	25
M12	300 mm	7.5 mm	49 mm	WS18	0053 912 300	1
M12	340 mm	7.5 mm	49 mm	WS18	0053 912 340	25
M14	60 mm	8.8 mm	34 mm	WS21	0053 914 60	50
M14	65 mm	8.8 mm	34 mm	WS21	0053 914 65	50
M14	70 mm	8.8 mm	34 mm	WS21	0053 914 70	50
M14	75 mm	8.8 mm	34 mm	WS21	0053 914 75	50
M14	80 mm	8.8 mm	34 mm	WS21	0053 914 80	50
M14	85 mm	8.8 mm	34 mm	WS21	0053 914 85	50
M14	90 mm	8.8 mm	34 mm	WS21	0053 914 90	50
M14	95 mm	8.8 mm	34 mm	WS21	0053 914 95	50
M14	100 mm	8.8 mm	34 mm	WS21	0053 914 100	50
M14	120 mm	8.8 mm	34 mm	WS21	0053 914 120	50
M14	130 mm	8.8 mm	40 mm	WS21	0053 914 130	50
M14	140 mm	8.8 mm	40 mm	WS21	0053 914 140	25
M14	150 mm	8.8 mm	40 mm	WS21	0053 914 150	25
M14	160 mm	8.8 mm	40 mm	WS21	0053 914 160	25
M14	210 mm	8.8 mm	53 mm	WS21	0053 914 210	25
M16	40 mm	10 mm	26 mm	WS24	0053 16 40	50
M16	45 mm	10 mm	26 mm	WS24	0053 16 45	50
M16	50 mm	10 mm	38 mm	WS24	0053 16 50	50
M16	55 mm	10 mm	38 mm	WS24	0053 16 55	50
M16	60 mm	10 mm	38 mm	WS24	0053 16 60	50
M16	65 mm	10 mm	38 mm	WS24	0053 16 65	25
M16	70 mm	10 mm	38 mm	WS24	0053 16 70	25
M16	75 mm	10 mm	38 mm	WS24	0053 16 75	25
M16	80 mm	10 mm	38 mm	WS24	0053 16 80	25
M16	85 mm	10 mm	38 mm	WS24	0053 16 85	25
M16	90 mm	10 mm	38 mm	WS24	0053 16 90	25
M16	95 mm	10 mm	38 mm	WS24	0053 16 95	25/50
M16	100 mm	10 mm	38 mm	WS24	0053 16 100	25
M16	110 mm	10 mm	38 mm	WS24	0053 16 110	25
M16	120 mm	10 mm	38 mm	WS24	0053 16 120	25
M16	125 mm	10 mm	38 mm	WS24	0053 16 125	25
M16	130 mm	10 mm	44 mm	WS24	0053 16 130	25
M16	140 mm	10 mm	44 mm	WS24	0053 16 140	25
M16	150 mm	10 mm	44 mm	WS24	0053 16 150	25
M16	155 mm	10 mm	44 mm	WS24	0053 16 155	25
M16	160 mm	10 mm	44 mm	WS24	0053 16 160	25
M16	170 mm	10 mm	44 mm	WS24	0053 16 170	25
M16	175 mm	10 mm	44 mm	WS24	0053 16 175	25
M16	180 mm	10 mm	44 mm	WS24	0053 16 180	25
M16	190 mm	10 mm	44 mm	WS24	0053 16 190	25
M16	200 mm	10 mm	44 mm	WS24	0053 16 200	10/25
M16	210 mm	10 mm	57 mm	WS24	0053 16 210	25
M16	220 mm	10 mm	57 mm	WS24	0053 16 220	1/25
M16	230 mm	10 mm	57 mm	WS24	0053 16 230	25
M16	240 mm	10 mm	57 mm	WS24	0053 16 240	25
M16	250 mm	10 mm	57 mm	WS24	0053 16 250	25
M16	260 mm	10 mm	57 mm	WS24	0053 16 260	25

Thread type x nominal diameter (d ₁)	Length (l ₁)	Head height (k ₁)	Thread length (metric thread) (b)	External drive (s ₁)	Art. no.	P. Qty.
M16	270 mm	10 mm	57 mm	WS24	0053 16 270	25
M16	280 mm	10 mm	57 mm	WS24	0053 16 280	25
M16	290 mm	10 mm	57 mm	WS24	0053 16 290	25
M16	300 mm	10 mm	57 mm	WS24	0053 16 300	25
M16	310 mm	10 mm	57 mm	WS24	0053 16 310	5
M16	320 mm	10 mm	57 mm	WS24	0053 16 320	25
M16	330 mm	10 mm	57 mm	WS24	0053 16 330	25
M16	340 mm	10 mm	57 mm	WS24	0053 16 340	25
M16	350 mm	10 mm	57 mm	WS24	0053 16 350	10
M16	360 mm	10 mm	57 mm	WS24	0053 16 360	10
M16	370 mm	10 mm	57 mm	WS24	0053 16 370	1
M16	420 mm	10 mm	57 mm	WS24	0053 16 420	10
M16	460 mm	10 mm	57 mm	WS24	0053 16 460	5
M16	520 mm	10 mm	57 mm	WS24	0053 16 520	10
M16	660 mm	10 mm	57 mm	WS24	0053 16 660	25
M16	700 mm	10 mm	57 mm	WS24	0053 16 700	25
M18	70 mm	11.5 mm	42 mm	WS27	0053 18 70	25
M18	75 mm	11.5 mm	42 mm	WS27	0053 18 75	50
M18	80 mm	11.5 mm	42 mm	WS27	0053 18 80	25
M18	85 mm	11.5 mm	42 mm	WS27	0053 18 85	25
M18	90 mm	11.5 mm	42 mm	WS27	0053 18 90	25
M18	100 mm	11.5 mm	42 mm	WS27	0053 18 100	25
M18	110 mm	11.5 mm	42 mm	WS27	0053 18 110	25
M18	120 mm	11.5 mm	42 mm	WS27	0053 18 120	25
M18	130 mm	11.5 mm	48 mm	WS27	0053 18 130	25
M18	140 mm	11.5 mm	48 mm	WS27	0053 18 140	25
M18	150 mm	11.5 mm	48 mm	WS27	0053 18 150	10
M18	160 mm	11.5 mm	48 mm	WS27	0053 18 160	25
M18	170 mm	11.5 mm	48 mm	WS27	0053 18 170	25
M18	180 mm	11.5 mm	48 mm	WS27	0053 18 180	25
M18	190 mm	11.5 mm	48 mm	WS27	0053 18 190	25
M18	200 mm	11.5 mm	48 mm	WS27	0053 18 200	25
M18	210 mm	11.5 mm	61 mm	WS27	0053 18 210	25
M18	220 mm	11.5 mm	61 mm	WS27	0053 18 220	25
M18	240 mm	11.5 mm	61 mm	WS27	0053 18 240	25
M18	260 mm	11.5 mm	61 mm	WS27	0053 18 260	10
M18	270 mm	11.5 mm	61 mm	WS27	0053 18 270	10
M18	280 mm	11.5 mm	61 mm	WS27	0053 18 280	10
M18	290 mm	11.5 mm	61 mm	WS27	0053 18 290	1
M18	300 mm	11.5 mm	61 mm	WS27	0053 18 300	10
M20	60 mm	12.5 mm	46 mm	WS30	0053 20 60	25
M20	70 mm	12.5 mm	46 mm	WS30	0053 20 70	25
M20	80 mm	12.5 mm	46 mm	WS30	0053 20 80	25
M20	85 mm	12.5 mm	46 mm	WS30	0053 20 85	25
M20	90 mm	12.5 mm	46 mm	WS30	0053 20 90	25
M20	95 mm	12.5 mm	46 mm	WS30	0053 20 95	25
M20	100 mm	12.5 mm	46 mm	WS30	0053 20 100	25
M20	105 mm	12.5 mm	46 mm	WS30	0053 20 105	25
M20	110 mm	12.5 mm	46 mm	WS30	0053 20 110	25
M20	115 mm	12.5 mm	46 mm	WS30	0053 20 115	10
M20	120 mm	12.5 mm	46 mm	WS30	0053 20 120	25
M20	125 mm	12.5 mm	46 mm	WS30	0053 20 125	25
M20	130 mm	12.5 mm	52 mm	WS30	0053 20 130	25

Thread type x nominal diameter (d ₁)	Length (l ₁)	Head height (k ₁)	Thread length (metric thread) (b)	External drive (s ₁)	Art. no.	P. Qty.
M20	140 mm	12.5 mm	52 mm	WS30	0053 20 140	25
M20	145 mm	12.5 mm	52 mm	WS30	0053 20 145	10
M20	150 mm	12.5 mm	52 mm	WS30	0053 20 150	10/25
M20	160 mm	12.5 mm	52 mm	WS30	0053 20 160	10
M20	170 mm	12.5 mm	52 mm	WS30	0053 20 170	10
M20	180 mm	12.5 mm	52 mm	WS30	0053 20 180	10
M20	185 mm	12.5 mm	52 mm	WS30	0053 20 185	10
M20	190 mm	12.5 mm	52 mm	WS30	0053 20 190	10
M20	200 mm	12.5 mm	52 mm	WS30	0053 20 200	10
M20	210 mm	12.5 mm	65 mm	WS30	0053 20 210	10
M20	220 mm	12.5 mm	65 mm	WS30	0053 20 220	10
M20	230 mm	12.5 mm	65 mm	WS30	0053 20 230	10
M20	240 mm	12.5 mm	65 mm	WS30	0053 20 240	1/10
M20	250 mm	12.5 mm	65 mm	WS30	0053 20 250	10
M20	260 mm	12.5 mm	65 mm	WS30	0053 20 260	1/10
M20	270 mm	12.5 mm	65 mm	WS30	0053 20 270	10
M20	280 mm	12.5 mm	65 mm	WS30	0053 20 280	1/10
M20	300 mm	12.5 mm	65 mm	WS30	0053 20 300	1/10
M20	310 mm	12.5 mm	65 mm	WS30	0053 20 310	10
M20	320 mm	12.5 mm	65 mm	WS30	0053 20 320	10
M20	330 mm	12.5 mm	65 mm	WS30	0053 20 330	1/10
M20	340 mm	12.5 mm	65 mm	WS30	0053 20 340	10
M20	350 mm	12.5 mm	65 mm	WS30	0053 20 350	10
M20	360 mm	12.5 mm	65 mm	WS30	0053 20 360	10
M20	380 mm	12.5 mm	65 mm	WS30	0053 20 380	10
M20	390 mm	12.5 mm	65 mm	WS30	0053 20 390	10
M20	400 mm	12.5 mm	65 mm	WS30	0053 20 400	10
M20	420 mm	12.5 mm	65 mm	WS30	0053 20 420	20
M20	440 mm	12.5 mm	65 mm	WS30	0053 20 440	5
M20	450 mm	12.5 mm	65 mm	WS30	0053 20 450	10
M20	460 mm	12.5 mm	65 mm	WS30	0053 20 460	10
M20	490 mm	12.5 mm	65 mm	WS30	0053 20 490	1
M20	520 mm	12.5 mm	65 mm	WS30	0053 20 520	10
M20	530 mm	12.5 mm	65 mm	WS30	0053 20 530	10
M20	660 mm	12.5 mm	65 mm	WS30	0053 20 660	1
M22	180 mm	14 mm	56 mm	WS34	0053 922 180	10
M24	85 mm	15 mm	54 mm	WS36	0053 24 85	10
M24	90 mm	15 mm	54 mm	WS36	0053 24 90	5/10
M24	95 mm	15 mm	54 mm	WS36	0053 24 95	10
M24	100 mm	15 mm	54 mm	WS36	0053 24 100	5/10
M24	110 mm	15 mm	54 mm	WS36	0053 24 110	5/10
M24	120 mm	15 mm	54 mm	WS36	0053 24 120	5/10
M24	130 mm	15 mm	60 mm	WS36	0053 24 130	5/10
M24	140 mm	15 mm	60 mm	WS36	0053 24 140	5/10
M24	145 mm	15 mm	60 mm	WS36	0053 24 145	5
M24	150 mm	15 mm	60 mm	WS36	0053 24 150	5/10
M24	160 mm	15 mm	60 mm	WS36	0053 24 160	5/10
M24	165 mm	15 mm	60 mm	WS36	0053 24 165	1
M24	170 mm	15 mm	60 mm	WS36	0053 24 170	10
M24	180 mm	15 mm	60 mm	WS36	0053 24 180	5/10
M24	190 mm	15 mm	60 mm	WS36	0053 24 190	10
M24	200 mm	15 mm	60 mm	WS36	0053 24 200	5/10
M24	210 mm	15 mm	73 mm	WS36	0053 24 210	10

Thread type x nominal diameter (d ₁)	Length (l ₁)	Head height (k ₁)	Thread length (metric thread) (b)	External drive (s ₁)	Art. no.	P. Qty.
M24	220 mm	15 mm	73 mm	WS36	0053 24 220	1/5/10
M24	230 mm	15 mm	73 mm	WS36	0053 24 230	10
M24	240 mm	15 mm	73 mm	WS36	0053 24 240	5/10
M24	250 mm	15 mm	73 mm	WS36	0053 24 250	10
M24	260 mm	15 mm	73 mm	WS36	0053 24 260	10
M24	270 mm	15 mm	73 mm	WS36	0053 24 270	10
M24	280 mm	15 mm	73 mm	WS36	0053 24 280	5
M24	310 mm	15 mm	73 mm	WS36	0053 24 310	10
M24	320 mm	15 mm	73 mm	WS36	0053 24 320	10
M24	330 mm	15 mm	73 mm	WS36	0053 24 330	10
M24	340 mm	15 mm	73 mm	WS36	0053 24 340	10
M24	360 mm	15 mm	73 mm	WS36	0053 24 360	10
M24	370 mm	15 mm	73 mm	WS36	0053 24 370	10
M24	380 mm	15 mm	73 mm	WS36	0053 24 380	10
M24	390 mm	15 mm	73 mm	WS36	0053 24 390	10
M24	400 mm	15 mm	73 mm	WS36	0053 24 400	5
M24	420 mm	15 mm	73 mm	WS36	0053 24 420	10
M24	440 mm	15 mm	73 mm	WS36	0053 24 440	5
M24	460 mm	15 mm	73 mm	WS36	0053 24 460	1
M24	480 mm	15 mm	73 mm	WS36	0053 24 480	10
M24	520 mm	15 mm	73 mm	WS36	0053 24 520	1
M24	560 mm	15 mm	73 mm	WS36	0053 24 560	10
M24	660 mm	15 mm	73 mm	WS36	0053 24 660	1
M27	100 mm	17 mm	60 mm	WS41	0053 27 100	1/5
M27	110 mm	17 mm	60 mm	WS41	0053 27 110	10
M27	120 mm	17 mm	60 mm	WS41	0053 27 120	10
M27	130 mm	17 mm	66 mm	WS41	0053 27 130	5
M27	140 mm	17 mm	66 mm	WS41	0053 27 140	10
M27	150 mm	17 mm	66 mm	WS41	0053 27 150	10
M27	160 mm	17 mm	66 mm	WS41	0053 27 160	10
M27	170 mm	17 mm	66 mm	WS41	0053 27 170	10
M27	180 mm	17 mm	66 mm	WS41	0053 27 180	5
M27	190 mm	17 mm	66 mm	WS41	0053 27 190	5
M27	200 mm	17 mm	66 mm	WS41	0053 27 200	10
M27	220 mm	17 mm	79 mm	WS41	0053 27 220	10
M27	240 mm	17 mm	79 mm	WS41	0053 27 240	10
M27	260 mm	17 mm	79 mm	WS41	0053 27 260	10
M27	280 mm	17 mm	79 mm	WS41	0053 27 280	10
M27	290 mm	17 mm	79 mm	WS41	0053 27 290	1
M27	300 mm	17 mm	79 mm	WS41	0053 27 300	10
M27	310 mm	17 mm	79 mm	WS41	0053 27 310	5
M27	320 mm	17 mm	79 mm	WS41	0053 27 320	5
M27	360 mm	17 mm	79 mm	WS41	0053 27 360	15
M27	380 mm	17 mm	79 mm	WS41	0053 27 380	10
M27	500 mm	17 mm	79 mm	WS41	0053 27 500	15
M30	100 mm	18.7 mm	66 mm	WS46	0053 30 100	10
M30	110 mm	18.7 mm	66 mm	WS46	0053 30 110	10
M30	120 mm	18.7 mm	66 mm	WS46	0053 30 120	1/10
M30	125 mm	18.7 mm	66 mm	WS46	0053 30 125	10
M30	130 mm	18.7 mm	72 mm	WS46	0053 30 130	1/5
M30	140 mm	18.7 mm	72 mm	WS46	0053 30 140	1/5/10
M30	150 mm	18.7 mm	72 mm	WS46	0053 30 150	1/10
M30	160 mm	18.7 mm	72 mm	WS46	0053 30 160	1/5/10

Thread type x nominal diameter (d ₁)	Length (l ₁)	Head height (k ₁)	Thread length (metric thread) (b)	External drive (s ₁)	Art. no.	P. Qty.
M30	170 mm	18.7 mm	72 mm	WS46	0053 30 170	10
M30	180 mm	18.7 mm	72 mm	WS46	0053 30 180	10
M30	190 mm	18.7 mm	72 mm	WS46	0053 30 190	10
M30	200 mm	18.7 mm	72 mm	WS46	0053 30 200	5
M30	210 mm	18.7 mm	85 mm	WS46	0053 30 210	10
M30	220 mm	18.7 mm	85 mm	WS46	0053 30 220	10
M30	230 mm	18.7 mm	85 mm	WS46	0053 30 230	5
M30	240 mm	18.7 mm	85 mm	WS46	0053 30 240	5
M30	250 mm	18.7 mm	85 mm	WS46	0053 30 250	10
M30	260 mm	18.7 mm	85 mm	WS46	0053 30 260	10
M30	270 mm	18.7 mm	85 mm	WS46	0053 30 270	10
M30	280 mm	18.7 mm	85 mm	WS46	0053 30 280	10
M30	290 mm	18.7 mm	85 mm	WS46	0053 30 290	1
M30	300 mm	18.7 mm	85 mm	WS46	0053 30 300	10
M30	310 mm	18.7 mm	85 mm	WS46	0053 30 310	10
M30	320 mm	18.7 mm	85 mm	WS46	0053 30 320	5
M30	360 mm	18.7 mm	85 mm	WS46	0053 30 360	1
M30	370 mm	18.7 mm	85 mm	WS46	0053 30 370	10
M30	380 mm	18.7 mm	85 mm	WS46	0053 30 380	5
M30	400 mm	18.7 mm	85 mm	WS46	0053 30 400	10
M30	420 mm	18.7 mm	85 mm	WS46	0053 30 420	10
M30	440 mm	18.7 mm	85 mm	WS46	0053 30 440	5
M30	460 mm	18.7 mm	85 mm	WS46	0053 30 460	1
M30	500 mm	18.7 mm	85 mm	WS46	0053 30 500	1
M30	520 mm	18.7 mm	85 mm	WS46	0053 30 520	1
M30	530 mm	18.7 mm	85 mm	WS46	0053 30 530	1
M30	550 mm	18.7 mm	85 mm	WS46	0053 30 550	1
M30	560 mm	18.7 mm	85 mm	WS46	0053 30 560	1
M30	680 mm	18.7 mm	85 mm	WS46	0053 30 680	5
M33	130 mm	21 mm	78 mm	WS50	0053 33 130	5
M33	140 mm	21 mm	78 mm	WS50	0053 33 140	5
M33	150 mm	21 mm	78 mm	WS50	0053 33 150	5
M33	160 mm	21 mm	78 mm	WS50	0053 33 160	10
M33	170 mm	21 mm	78 mm	WS50	0053 33 170	5
M33	190 mm	21 mm	78 mm	WS50	0053 33 190	1
M33	210 mm	21 mm	91 mm	WS50	0053 33 210	10
M33	220 mm	21 mm	91 mm	WS50	0053 33 220	10
M33	230 mm	21 mm	91 mm	WS50	0053 33 230	5
M33	240 mm	21 mm	91 mm	WS50	0053 33 240	5
M33	250 mm	21 mm	91 mm	WS50	0053 33 250	10
M33	260 mm	21 mm	91 mm	WS50	0053 33 260	5
M33	280 mm	21 mm	91 mm	WS50	0053 33 280	5
M33	300 mm	21 mm	91 mm	WS50	0053 33 300	10
M33	340 mm	21 mm	91 mm	WS50	0053 33 340	5
M33	430 mm	21 mm	91 mm	WS50	0053 33 430	5
M36	140 mm	22.5 mm	84 mm	WS55	0053 36 140	5
M36	150 mm	22.5 mm	84 mm	WS55	0053 36 150	5
M36	160 mm	22.5 mm	84 mm	WS55	0053 36 160	5
M36	170 mm	22.5 mm	84 mm	WS55	0053 36 170	5
M36	180 mm	22.5 mm	84 mm	WS55	0053 36 180	10
M36	190 mm	22.5 mm	84 mm	WS55	0053 36 190	5
M36	200 mm	22.5 mm	84 mm	WS55	0053 36 200	10
M36	220 mm	22.5 mm	97 mm	WS55	0053 36 220	5

Thread type x nominal diameter (d ₁)	Length (l ₁)	Head height (k ₁)	Thread length (metric thread) (b)	External drive (s ₁)	Art. no.	P. Qty.
M36	230 mm	22.5 mm	97 mm	WS55	0053 36 230	5
M36	240 mm	22.5 mm	97 mm	WS55	0053 36 240	5
M36	260 mm	22.5 mm	97 mm	WS55	0053 36 260	5
M36	280 mm	22.5 mm	97 mm	WS55	0053 36 280	5
M36	290 mm	22.5 mm	97 mm	WS55	0053 36 290	5
M36	300 mm	22.5 mm	97 mm	WS55	0053 36 300	10
M36	320 mm	22.5 mm	97 mm	WS55	0053 36 320	1
M36	330 mm	22.5 mm	97 mm	WS55	0053 36 330	5
M36	340 mm	22.5 mm	97 mm	WS55	0053 36 340	1
M36	360 mm	22.5 mm	97 mm	WS55	0053 36 360	5
M36	380 mm	22.5 mm	97 mm	WS55	0053 36 380	4
M36	440 mm	22.5 mm	97 mm	WS55	0053 36 440	1
M36	460 mm	22.5 mm	97 mm	WS55	0053 36 460	5
M36	560 mm	22.5 mm	97 mm	WS55	0053 36 560	1
M39	150 mm	25 mm	90 mm	WS60	0053 39 150	1
M39	200 mm	25 mm	90 mm	WS60	0053 39 200	10
M39	350 mm	25 mm	103 mm	WS60	0053 39 350	5
M42	160 mm	26 mm	96 mm	WS65	0053 42 160	5
M42	170 mm	26 mm	96 mm	WS65	0053 42 170	5
M42	180 mm	26 mm	96 mm	WS65	0053 42 180	5
M42	190 mm	26 mm	96 mm	WS65	0053 42 190	10
M42	200 mm	26 mm	96 mm	WS65	0053 42 200	5
M42	210 mm	26 mm	109 mm	WS65	0053 42 210	10
M42	220 mm	26 mm	109 mm	WS65	0053 42 220	5
M42	240 mm	26 mm	109 mm	WS65	0053 42 240	5
M42	260 mm	26 mm	109 mm	WS65	0053 42 260	5
M42	280 mm	26 mm	109 mm	WS65	0053 42 280	1
M42	300 mm	26 mm	109 mm	WS65	0053 42 300	5
M42	320 mm	26 mm	109 mm	WS65	0053 42 320	5
M42	380 mm	26 mm	109 mm	WS65	0053 42 380	5
M45	170 mm	28 mm	102 mm	WS70	0053 45 170	5
M45	180 mm	28 mm	102 mm	WS70	0053 45 180	5
M45	190 mm	28 mm	102 mm	WS70	0053 45 190	20
M45	200 mm	28 mm	115 mm	WS70	0053 45 200	1
M45	210 mm	28 mm	115 mm	WS70	0053 45 210	5
M45	220 mm	28 mm	115 mm	WS70	0053 45 220	1
M45	240 mm	28 mm	115 mm	WS70	0053 45 240	5
M48	180 mm	30 mm	108 mm	WS75	0053 48 180	1
M48	190 mm	30 mm	108 mm	WS75	0053 48 190	5
M48	200 mm	30 mm	108 mm	WS75	0053 48 200	5
M48	210 mm	30 mm	121 mm	WS75	0053 48 210	1
M48	240 mm	30 mm	121 mm	WS75	0053 48 240	1
M48	260 mm	30 mm	121 mm	WS75	0053 48 260	5
M48	300 mm	30 mm	121 mm	WS75	0053 48 300	1
M48	360 mm	30 mm	121 mm	WS75	0053 48 360	5
M48	400 mm	30 mm	121 mm	WS75	0053 48 400	5
M52	170 mm	33 mm	116 mm	WS80	0053 52 170	10
M52	200 mm	33 mm	129 mm	WS80	0053 52 200	1
M52	260 mm	33 mm	129 mm	WS80	0053 52 260	5
M52	280 mm	33 mm	129 mm	WS80	0053 52 280	5
M56	220 mm	35 mm	137 mm	WS85	0053 56 220	5
M56	280 mm	35 mm	137 mm	WS85	0053 56 280	1
M56	300 mm	35 mm	137 mm	WS85	0053 56 300	5

Thread type x nominal diameter (d ₁)	Length (l ₁)	Head height (k ₁)	Thread length (metric thread) (b)	External drive (s ₁)	Art. no.	P. Qty.
M56	320 mm	35 mm	137 mm	WS85	0053 56 320	2
M56	460 mm	35 mm	137 mm	WS85	0053 56 460	1
M56	840 mm	35 mm	137 mm	WS85	0053 56 840	1
M56	940 mm	35 mm	137 mm	WS85	0053 56 940	1
M64	260 mm	40 mm	153 mm	WS95	0053 64 260	5
M64	340 mm	40 mm	153 mm	WS95	0053 64 340	5
M64	360 mm	40 mm	153 mm	WS95	0053 64 360	1
M64	460 mm	40 mm	153 mm	WS95	0053 64 460	1
M64	500 mm	40 mm	153 mm	WS95	0053 64 500	5

Notice

ISO 4014 replaces DIN 931 | There is some similarity | Nominal dimensions extended | Width across flats changed for M10, M12, M14 and M22.