

# HEXAGONAL BOLT WITH SHANK

ISO 4014 stainless steel A2-50  
and A2-70, plain

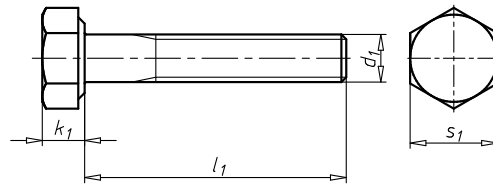

Thread type x nominal diameter (d <sub>1</sub> )	Length (l <sub>1</sub> )	Head height (k <sub>1</sub> )	External drive (s <sub>1</sub> )	Property class	Product class	Art. No.	P. Qty.
M6	30 mm	4 mm	WS10	70	A	<b>0095 6 30</b>	100
M6	35 mm	4 mm	WS10	70	A	<b>0095 6 35</b>	100
M6	40 mm	4 mm	WS10	70	A	<b>0095 6 40</b>	100
M6	45 mm	4 mm	WS10	70	A	<b>0095 6 45</b>	100
M6	50 mm	4 mm	WS10	70	A	<b>0095 6 50</b>	100
M6	55 mm	4 mm	WS10	70	A	<b>0095 6 55</b>	100
M6	60 mm	4 mm	WS10	70	A	<b>0095 6 60</b>	100
M6	65 mm	4 mm	WS10	70	B	<b>0095 6 65</b>	100
M6	70 mm	4 mm	WS10	70	B	<b>0095 6 70</b>	50
M6	75 mm	4 mm	WS10	70	B	<b>0095 6 75</b>	200
M6	80 mm	4 mm	WS10	70	B	<b>0095 6 80</b>	50
M6	85 mm	4 mm	WS10	70	B	<b>0095 6 85</b>	100
M6	90 mm	4 mm	WS10	70	B	<b>0095 6 90</b>	50
M6	95 mm	4 mm	WS10	70	B	<b>0095 6 95</b>	100
M6	100 mm	4 mm	WS10	70	B	<b>0095 6 100</b>	100
M6	105 mm	4 mm	WS10	70	B	<b>0095 6 105</b>	100
M6	110 mm	4 mm	WS10	70	B	<b>0095 6 110</b>	100
M6	120 mm	4 mm	WS10	70	B	<b>0095 6 120</b>	100
M6	130 mm	4 mm	WS10	70	B	<b>0095 6 130</b>	100
M6	140 mm	4 mm	WS10	70	B	<b>0095 6 140</b>	100
M6	150 mm	4 mm	WS10	70	B	<b>0095 6 150</b>	100
M6	160 mm	4 mm	WS10	70	B	<b>0095 6 160</b>	100
M8	30 mm	5.3 mm	WS13	70	A	<b>0095 8 30</b>	100
M8	40 mm	5.3 mm	WS13	70	A	<b>0095 8 40</b>	100
M8	45 mm	5.3 mm	WS13	70	A	<b>0095 8 45</b>	100
M8	50 mm	5.3 mm	WS13	70	A	<b>0095 8 50</b>	100
M8	55 mm	5.3 mm	WS13	70	A	<b>0095 8 55</b>	100
M8	60 mm	5.3 mm	WS13	70	A	<b>0095 8 60</b>	100
M8	65 mm	5.3 mm	WS13	70	A	<b>0095 8 65</b>	100
M8	70 mm	5.3 mm	WS13	70	A	<b>0095 8 70</b>	50
M8	75 mm	5.3 mm	WS13	70	A	<b>0095 8 75</b>	50
M8	80 mm	5.3 mm	WS13	70	A	<b>0095 8 80</b>	50
M8	85 mm	5.3 mm	WS13	70	B	<b>0095 8 85</b>	100
M8	90 mm	5.3 mm	WS13	70	B	<b>0095 8 90</b>	50
M8	95 mm	5.3 mm	WS13	70	B	<b>0095 8 95</b>	100
M8	100 mm	5.3 mm	WS13	70	B	<b>0095 8 100</b>	50
M8	110 mm	5.3 mm	WS13	70	B	<b>0095 8 110</b>	50
M8	120 mm	5.3 mm	WS13	70	B	<b>0095 8 120</b>	50
M8	130 mm	5.3 mm	WS13	70	B	<b>0095 8 130</b>	50
M8	135 mm	5.3 mm	WS13	70	B	<b>0095 8 135</b>	100
M8	140 mm	5.3 mm	WS13	70	B	<b>0095 8 140</b>	50
M8	150 mm	5.3 mm	WS13	70	B	<b>0095 8 150</b>	50
M8	160 mm	5.3 mm	WS13	70	B	<b>0095 8 160</b>	50
M8	170 mm	5.3 mm	WS13	70	B	<b>0095 8 170</b>	50
M8	180 mm	5.3 mm	WS13	70	B	<b>0095 8 180</b>	50