

HEXAGONAL BOLT WITH SHANK

ISO 4014 stainless steel A4-50
and A4-70, plain

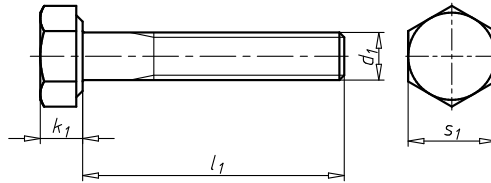

Thread type x nominal diameter (d ₁)	Length (l ₁)	Head height (k ₁)	External drive (s ₁)	Property class	Product class	Art. No.	P. Qty.
M24	80 mm	15 mm	WS36	70	A	0090 24 80	10
M24	85 mm	15 mm	WS36	70	A	0090 24 85	10
M24	90 mm	15 mm	WS36	70	A	0090 24 90	10
M24	100 mm	15 mm	WS36	70	A	0090 24 100	10
M24	110 mm	15 mm	WS36	70	A	0090 24 110	10
M24	120 mm	15 mm	WS36	70	A	0090 24 120	10
M24	130 mm	15 mm	WS36	70	A	0090 24 130	10
M24	140 mm	15 mm	WS36	70	A	0090 24 140	10
M24	150 mm	15 mm	WS36	70	A	0090 24 150	10
M24	160 mm	15 mm	WS36	70	B	0090 24 160	10
M24	170 mm	15 mm	WS36	70	B	0090 24 170	10
M24	180 mm	15 mm	WS36	70	B	0090 24 180	5
M24	190 mm	15 mm	WS36	70	B	0090 24 190	10
M24	200 mm	15 mm	WS36	70	B	0090 24 200	10
M24	210 mm	15 mm	WS36	70	B	0090 24 210	5
M24	220 mm	15 mm	WS36	70	B	0090 24 220	5
M24	230 mm	15 mm	WS36	70	B	0090 24 230	5
M24	240 mm	15 mm	WS36	70	B	0090 24 240	5
M24	250 mm	15 mm	WS36	70	B	0090 24 250	5
M24	260 mm	15 mm	WS36	70	B	0090 24 260	10
M24	270 mm	15 mm	WS36	70	B	0090 24 270	10
M24	280 mm	15 mm	WS36	70	B	0090 24 280	10
M27	90 mm	17 mm	WS41	50	B	0090 27 90	5
M27	100 mm	17 mm	WS41	50	B	0090 27 100	5
M27	110 mm	17 mm	WS41	50	B	0090 27 110	10
M27	120 mm	17 mm	WS41	50	B	0090 27 120	10
M27	130 mm	17 mm	WS41	50	B	0090 27 130	5
M27	140 mm	17 mm	WS41	50	B	0090 27 140	5
M27	150 mm	17 mm	WS41	50	B	0090 27 150	5
M27	160 mm	17 mm	WS41	50	B	0090 27 160	5
M27	180 mm	17 mm	WS41	50	B	0090 27 180	5
M27	190 mm	17 mm	WS41	50	B	0090 27 190	5
M27	200 mm	17 mm	WS41	50	B	0090 27 200	5
M27	210 mm	17 mm	WS41	50	B	0090 27 210	5
M27	230 mm	17 mm	WS41	50	B	0090 27 230	5
M27	240 mm	17 mm	WS41	50	B	0090 27 240	5
M27	260 mm	17 mm	WS41	50	B	0090 27 260	5
M27	270 mm	17 mm	WS41	50	B	0090 27 270	1
M27	300 mm	17 mm	WS41	50	B	0090 27 300	5